



# INSTALLATION INSTRUCTIONS

MAKE: Toyota  
MODEL: Sequoia  
YEAR: 2023  
ENGINE: V6-3.4L (tt)

Cat-Back Exhaust

49-36068-B

49-36068-P

**NOTE: Only Fits TRD Models**

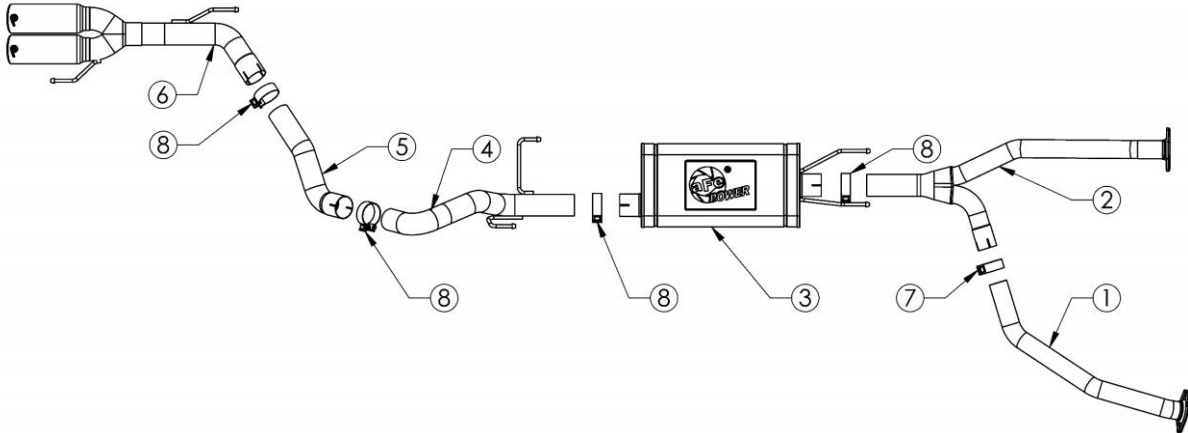

Item	Description	Part Number	Quantity
1	Passenger Side Front Pipe	05-245484	1
2	Y-Pipe	05-245485	2
3	Muffler Assembly	05-245490	1
4	Over-Axle Pipe	05-245486	1
5	Connection Pipe	05-245487	1
6	Tailpipe	05-245488	1
7	Clamp, Band: 2-1/2"	05-41061	1
8	Clamp, Band: 3"	05-41055	4

**aFe POWER recommends professional installation on this product.** Thoroughly inspect the aFe POWER exhaust system to make sure there is no damage from shipping (if damage is noted, immediately contact aFe POWER customer service). Allow time for your vehicle to cool down prior to installation. When working on your vehicle proceed with caution. Wear protective safety equipment; eye goggles and gloves to ensure a safe installation.

Install band clamps to proper torque specifications of 40-45 ft-lb.

Install V-band clamps with anti-seize lubricant and hand tighten only to torque specifications of 10-15 ft-lb.





## INSTALLATION INSTRUCTIONS

**MAKE:** Toyota  
**MODEL:** Sequoia  
**YEAR:** 2023  
**ENGINE:** V6-3.4L (tt)

**Cat-Back Exhaust**

49-36068-B

49-36068-P

**NOTE: Only Fits TRD Models**

1. **(Read instructions prior to installation.)** It is recommended to not fully tighten the exhaust until it has been fully installed. Leave loose for adjustability.
2. Secure vehicle on jack stands (refer to your manual for specified jack stand positions).
3. For faster installation, spread out the parts of the exhaust alongside your vehicle as shown in the diagram above.  
**NOTE: Without a vehicle lift, it may be necessary to cut the OE exhaust to remove it from the vehicle.**
4. Lower the spare tire to allow for clearance for exhaust removal.
5. Lift the vehicle and secure it on a vehicle lift or jack stands.
6. Secure the stock exhaust with jack/stands.
7. Remove the O.E. Bolts and Springs at the front of the vehicle's exhaust. Retain the hardware, it will be re-used for installation of the aFe POWER exhaust.
8. Remove the OE exhaust hangers from the isolators. Be careful not to damage the isolators.
9. Lower the front of the O.E Exhaust, and then snake the exhaust around the rear axle and remove it from the vehicle.
10. Install the aFe Power Passenger Side Front Pipe onto the aFe Power Y-Pipe using the supplied 2-1/2" Band Clamp. Do not fully tighten Band Clamp to allow for adjustment. Install this Assembly onto the O.E. Catalytic Converters using the O.E. Springs and Bolts.
11. Install the aFe Power Muffler Assembly with the Supplied 3" Band Clamp and install the hangers into the vehicle's isolator mounts.
12. Install the aFe Power Over-Axle Pipe with the supplied 3" band clamp and install the hangers into the vehicle's isolator mount.
13. Install the aFe Power Connection Pipe with the supplied 3" band clamp.
14. Install the aFe Power Tailpipe with the supplied 3" band clamp and install the hangers into the vehicle's isolator mounts.
15. Ensure that all the components of the aFe POWER exhaust system are aligned and are at a safe clearance from all wires, hoses, brake lines, body parts, and tires.
16. Start from the front of the aFe exhaust system and evenly tighten all clamps and fasteners.
17. Start the vehicle and check for any leaks. If any leaks are found, determine cause and repair as necessary.
18. Lower the vehicle back to the ground and secure the spare tire.
19. It is recommended to re-tighten all clamps and hardware after 50-100 miles.