

advanced FLOW engineering Stage-2 Air Intake System

Instruction Manual P/N: 56-10004DR

Make: Infiniti
Make: Infiniti

Model: Q50
Model: Q60

Year: 2016-2023
Year: 2017-2022

Engine: V6-3.0L(tt)
Engine: V6-3.0L(tt)



- Please read the entire instruction manual before proceeding.
- Ensure all components listed are present.
- If you are missing any of the components, call customer support at 951-493-7185.
- Ensure you have all necessary tools before proceeding.
- Do not attempt to work on your vehicle when the engine is hot.
- Retain factory parts for future use.

Label	Qty.	Description	Part Number
A	2	Air Filter (Pro DRY S)	TF-9029D
B	1	Tube: Passenger Side	05-5610004R1
C	1	Tube: Driver Side	05-5610004R2
D	1	Housing: Passenger side	05-5610004R3
E	1	Housing: Driver Side	05-5610004R4
F	1	Coupling, Silicone: (2-3/4"x2-1/4")ID x 55Deg	05-01488
G	1	Coupling, Silicone: (2-3/4"x2-1/4")ID x 2-1/2"L	05-01489
H	2	Clamp, 032 (3-1/16" - 4")	03-50016
I	2	Clamp, 044 (2-9/16" - 3-1/2")	03-50019
J	4	Screw, Torx: M4	03-50491
K	1	Seal, Trim: 3/4" Bulb (22"L)	05-01507

Installation will require the following tools:

T-20 Torx driver, 8mm nut driver, small flat-head screwdriver, Philips screwdriver, 10mm deep and shallow socket, ratchet, ratchet extension, Pliers.

NOTE: All Installation photos are of the black version of this kit. All steps are the same.

Warranty Information available at: <https://afepower.com/contact#warranty>

Emissions Disclaimer: This product is not currently CARB exempt and is not available for purchase in California or for use on any vehicle registered with the California Department of Motor Vehicles.

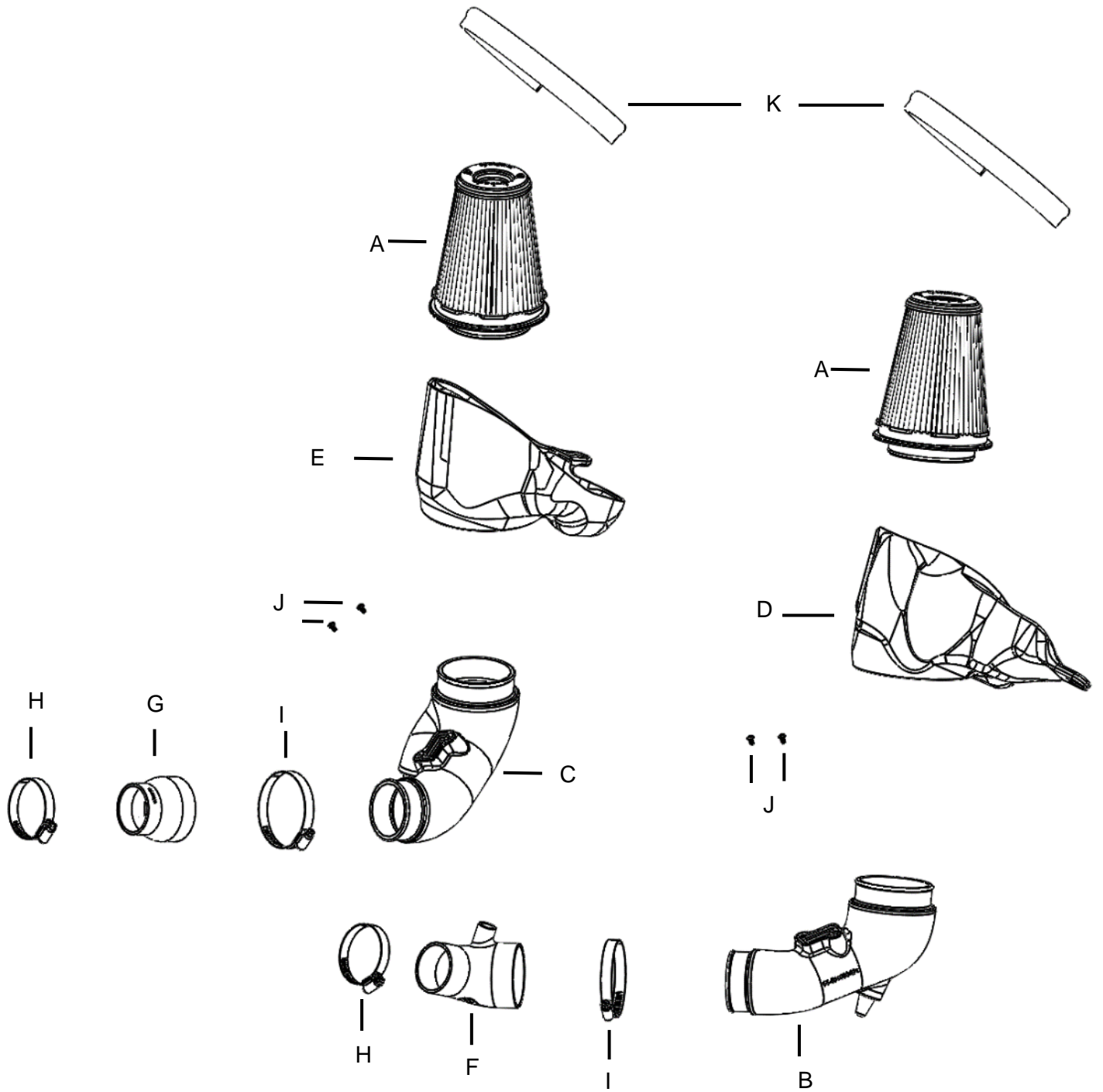

**Figure A****Refer to Figure A for Steps 1-2**

Step 1: Unclip the 8 push clips on the factory air scoop ①.

Step 2: Remove factory air scoop out of vehicle.

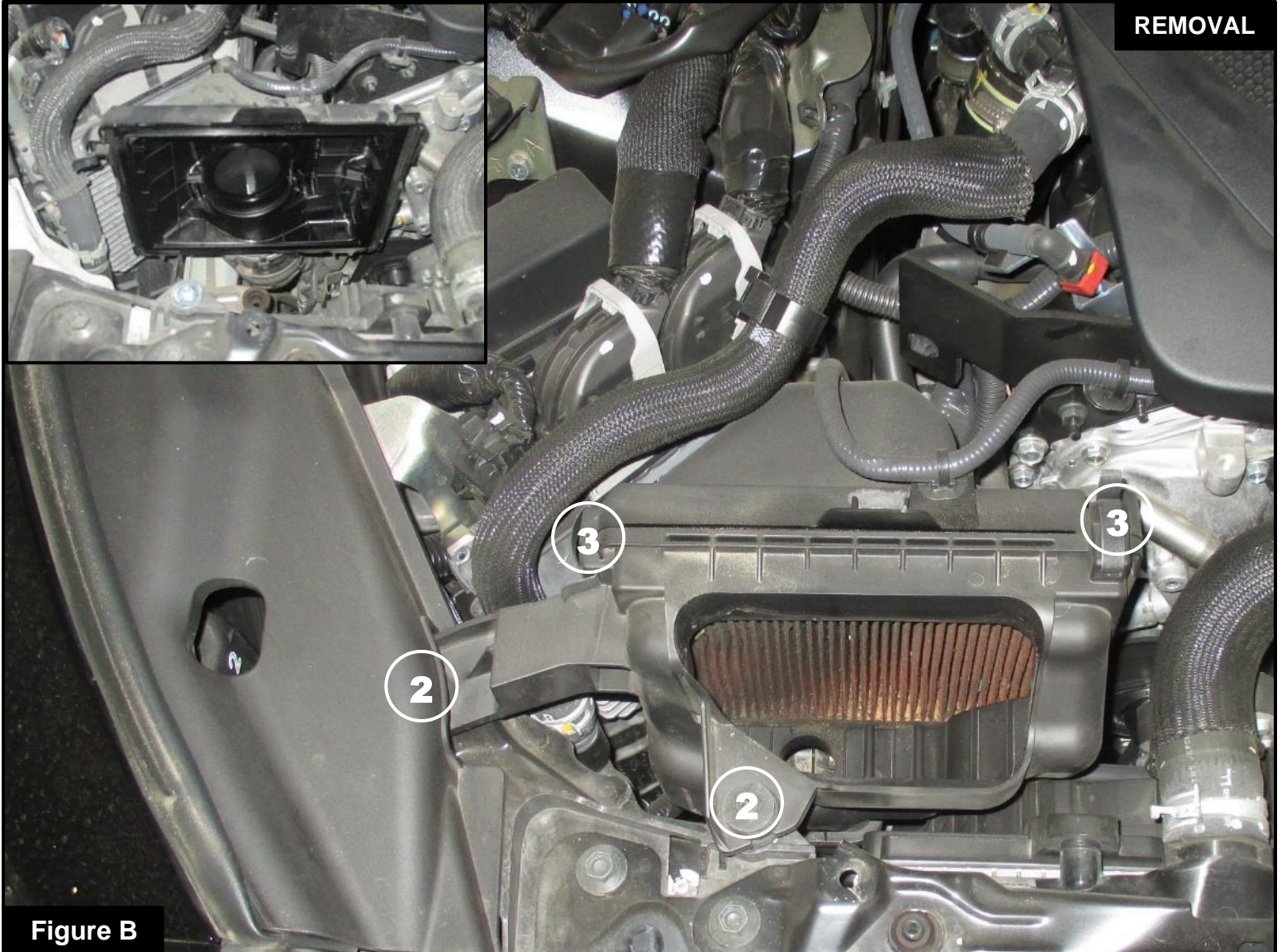

Refer to Figure B for Step 3-4

Step 3: With a short 10mm socket remove the two bolts securing the passenger side factory air box. (Do the same thing for the factory airbox on the driver side) ②.

Step 4: Unclip the two retaining tabs on the factory air box to open it. Take the front half of the factory air box out of the vehicle by pulling upward on it and popping it off its mounting grommet. Remove the factory air filter. Repeat this operation for the driver side air box. ③.



Refer to Figure C for Step 5

Step 5: Disconnect both Mass Air Flow sensors (4) and unclip the harnesses from the factory air box (5).

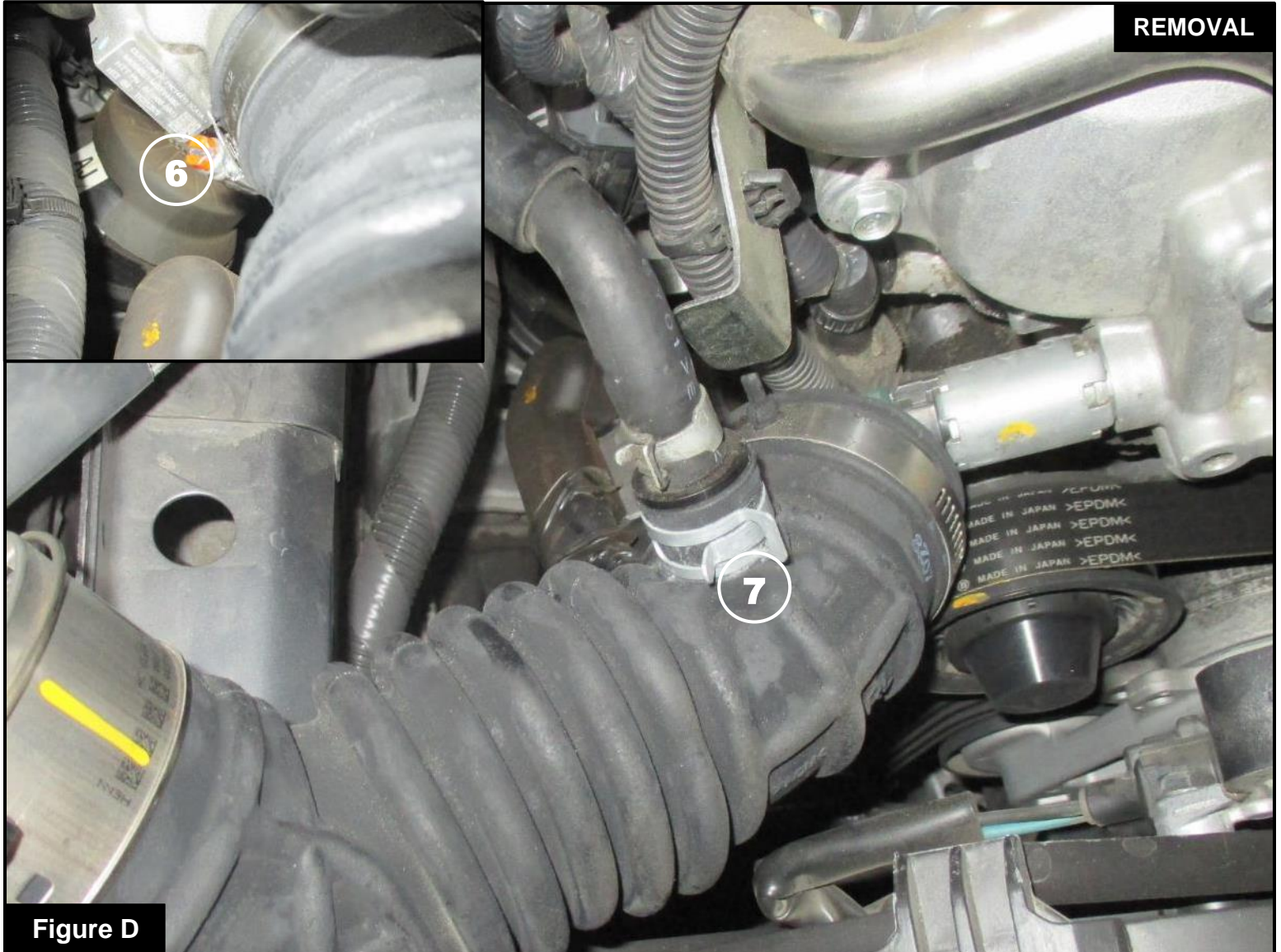

Refer to Figure D for Steps 6-8

- Step 6: Loosen the clamp securing the passenger side factory intake tube to the turbo inlet (6). Repeat the operation for the tube on the driver side.
- Step 7: On the passenger side open the spring clamp with pliers and pull the barbed crank case fitting out of the factory tube. Save the factory spring clamp for installation of the Takeda intake.
- Step 8: Remove the other half of the passenger side factory air intake system out of the vehicle. Do the same thing for the driver side air intake system.

**Figure E****Refer to Figure E for Steps 9-10**

Step 9: Transfer the MAF sensor from the passenger side factory intake to the passenger side Takeda intake tube (05-5610004B2). Secure it with the provided hardware (7).

Step 10: Preinstall the elbow coupling with the port (F) onto the Takeda intake tube. Install one small and one big clamp but do not tighten clamps at this time .

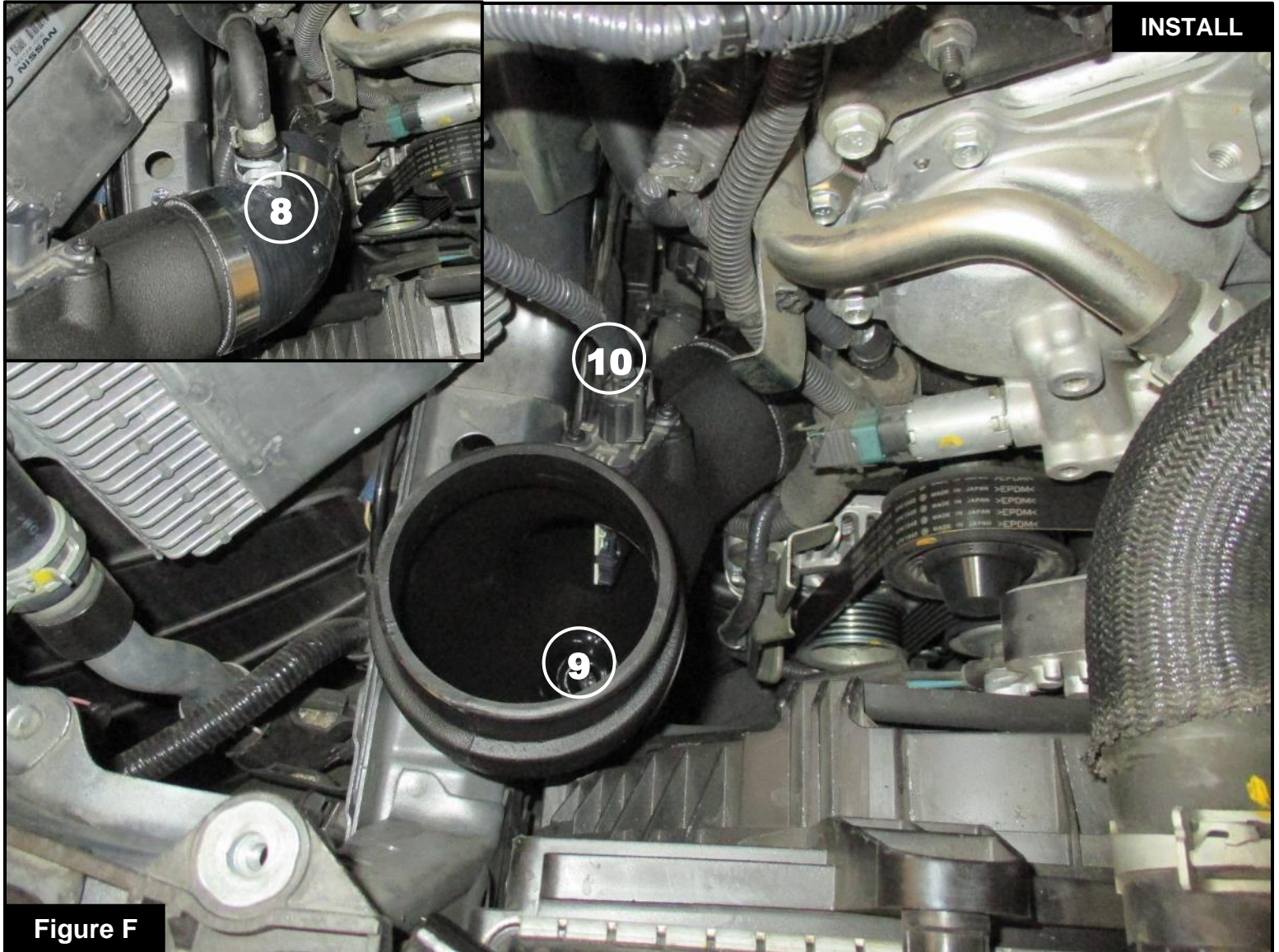

Figure F

Refer to Figure F for Step 11-14

- Step 11: Install the factory barbed crank case fitting into the Takeda coupling. Secure it with the factory clamp ⑧.
- Step 12: Install the Takeda coupling over the turbo inlet then locate the peg of the tube into the factory grommet location ⑨.
- Step 13: Align the intake tube and coupling rotation. Make sure the intake tube is sitting flush into the factory grommet. Tighten first the clamp on the turbo inlet then the clamp between the coupling and the tube.
- Step 14: Reconnect the MAF sensor harness ⑩.

**Figure G****Refer to Figure G for Steps 15**

Step 15: Transfer the MAF sensor from the driver side factory intake to the Takeda intake tube (05-5610004B1). Secure it with the provided hardware (11) .

**Figure H****Refer to Figure H for Steps 16-19**

Step 16: Install the reducer coupling onto the driver side turbo inlet (12) . Place the clamps but do not tighten.

Step 17: Install the intake tube into the coupling then locate the peg into the factory grommet.

Step 18: Align the intake tube and coupling,make sure the mounting peg is sitting flush into the factory grommet (13) . Tighten clamps at this time.

Step 19: Reconnect the MAF sensor harness (14) .

**Figure I****Refer to Figure I for Steps 20-22**

Step 20: Transfer both factory grommets with metal sleeve from the factory housing to Takeda housing(05-5610004B4).

Step 21: Install the trim seal into onto the top edge of housing.

Step 22: Install the Takeda air filter into the Takeda housing with clamp. Assure the locking tabs snap onto the housing.

(Repeat steps 20-22 for Driver side housing)

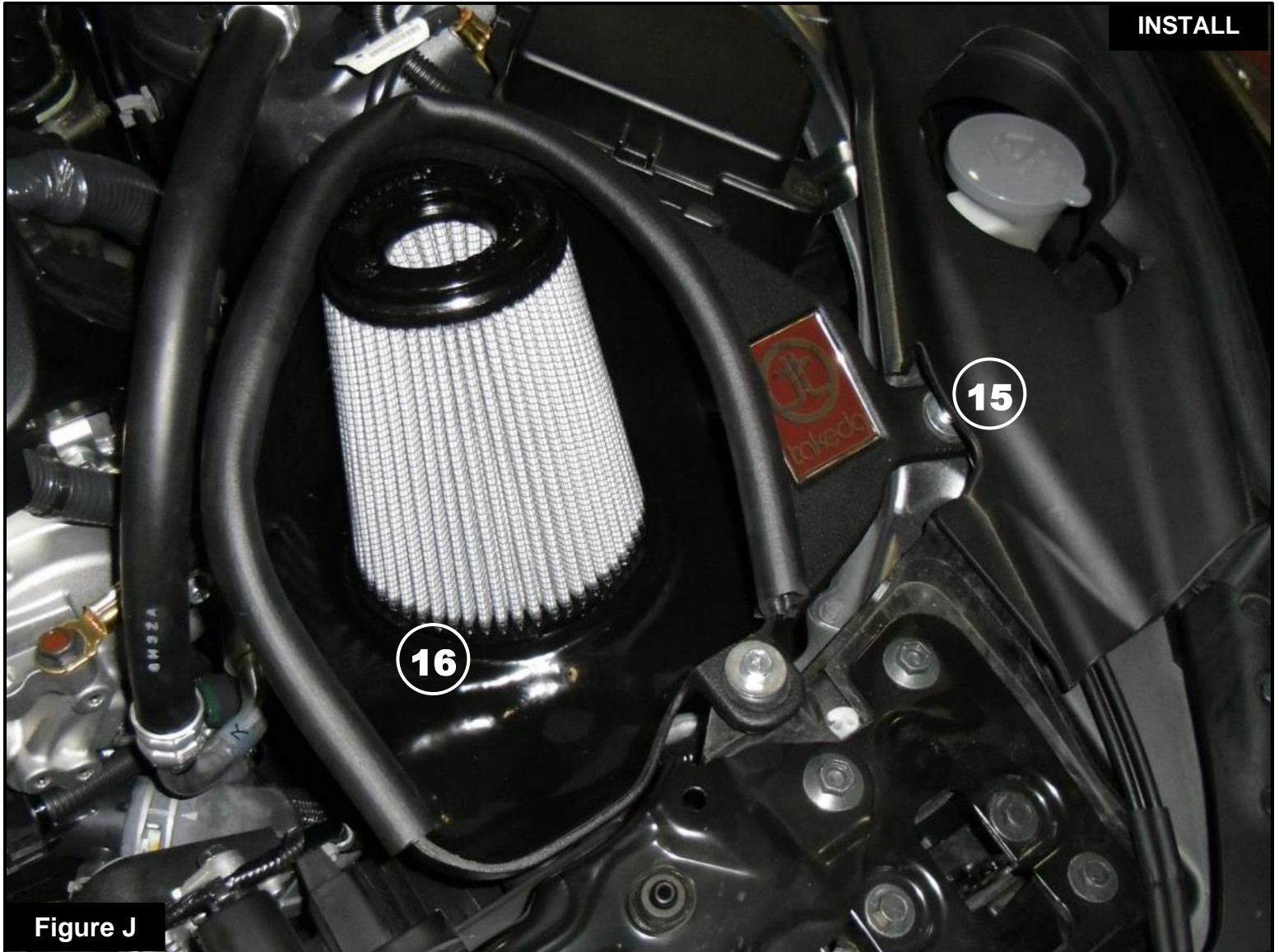
**Figure J**

Refer to Figure J for Steps 23-25

Step 23: First locate the Takeda housing on the factory location next to the fender (15) then insert the intake tube into the air filter (16).

Step 24: Secure the housing to the factory locations with the factory bolts.

Step 25: Make sure to tighten the clamp at the filter flange.

(Repeat steps 23-25 the driver side housing)



Figure K

Refer to Figure K for Steps 26

Step 26: Verify all bolts and clamps are tight and secure.

**Figure L****Refer to Figure L for Steps 27**

Step 27: Re-install the factory air scoop inlet with the factory push clips. The installation is now complete.

NOTE: Check all bolts, clamps, and connectors after 100-200 miles.



advanced FLOW engineering, inc.

Corona, CA 92879

<https://afepower.com/contact>