

aFe Control Wheel Spacers BMW E & F-Series

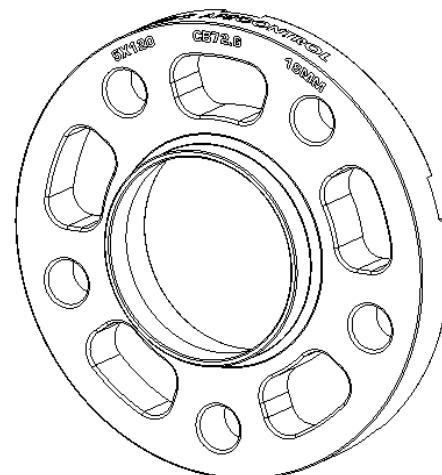

KIT	Description
610-502001-B	Wheel Spacer Kit 5x120, CB72.6, 12.5mm
610-502002-B	Wheel Spacer Kit 5x120, CB72.6, 15mm
610-502003-B	Wheel Spacer Kit 5x120, CB72.6, 18mm
610-502004-B	Wheel Spacer Kit 5x120, CB72.6, 20mm

Warning: Before you begin, make sure you have the proper length lug bolts (not included) for the spacer you intend to use. If you are starting from stock form, you can add your current lug bolt length to the spacer thickness to determine the proper lug bolt length. You can round up a few mm's but be aware, using too long of a lug bolt can cause the bolt to protrude too far inboard and cause interference. A good rule of thumb for safe thread engagement is M12-1.5 (6.5 TURNS), M14-1.25 (9.5 TURNS), M14-1.5 (8 TURNS). **OEM BMW lug bolt length=27mm.** Wheel stud conversions are also an option.

Procedure:

1. Raise vehicle at factory jack points and remove wheels.
2. Make sure the hub and wheel mating surfaces are clean and free of debris.
3. Place the aFe CONTROL wheel spacer onto the hub. Check for hub clearance. (Diagram A) Max allowable hub height on spacer must be equal or greater than the hub height on car. Your car may have a plastic hub cap, which can be removed to gain a few mm. (Diagram B)
4. Position the spacer so the mounting holes line up.
5. Reinstall the wheel onto the spacer/hub. Snugly tighten the lug bolts and ensure the wheel is firmly installed.
6. Spin the wheel to make sure there is no interference.
7. Fully torque the lug bolts in a star pattern to factory specifications.

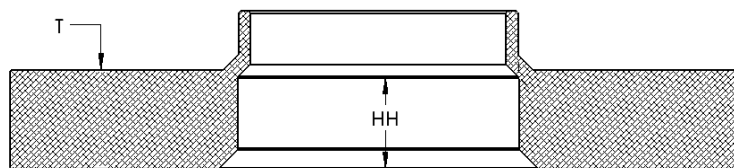

Spacer Thickness (T)	Max Allowable Hub Height (HH)
12.5mm	13mm
15mm	14mm
18mm	17mm
20mm	19mm

