



INSTALLATION INSTRUCTIONS

Twisted Steel Y-Pipe

MAKE: Toyota
MODEL: Tacoma
YEAR: 2016-2017
ENGINE: V6-3.5L

48-46011-RC

This system will NOT fit 4WD Tacoma models

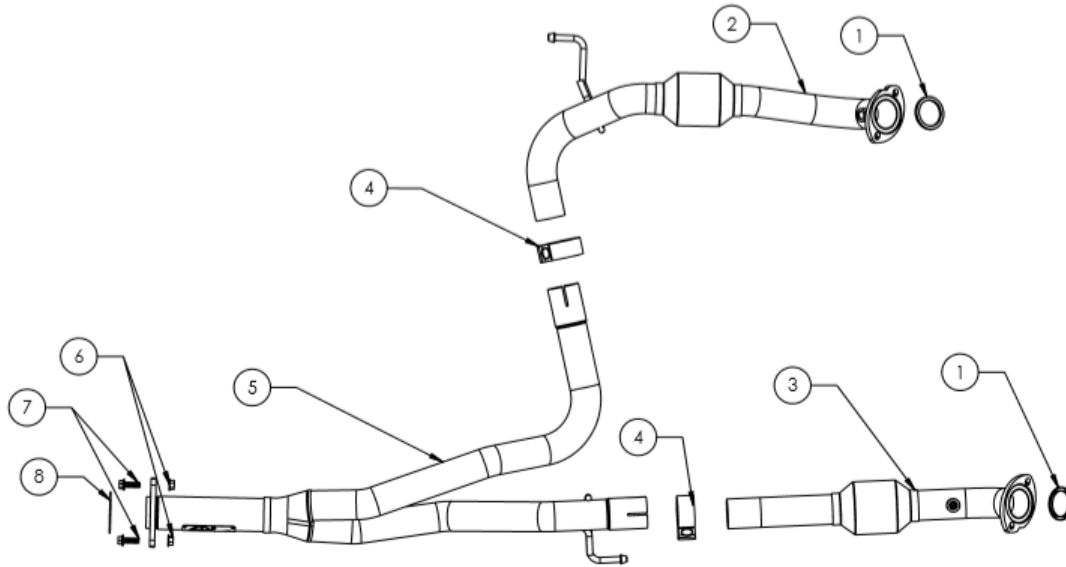

Item	Description	Part Number	Quantity
1	Crush Gasket	05-60366	2
2	Y-Pipe, Passenger Side	05-144808	1
3	Y-Pipe, Driver Side	05-144809	1
4	2-1/4" Band Clamp	05-41210	2
5	Collector Assembly	05-144810	1
6	10mm x 1.25 Nut	03-50400	2
7	10mm x 1.25 x 35mm	03-50401	2
8	Pipe Gasket	05-46420	1

aFe POWER recommends professional installation on this product. Thoroughly inspect the aFe POWER exhaust system to make sure there is no damage from shipping (if damage is noted, immediately contact aFe POWER customer service). Allow time for your vehicle to cool down prior to installation. When working on your vehicle proceed with caution. Wear protective safety equipment; eye goggles and gloves to ensure a safe installation.

Install band clamps to proper torque specifications of 40-45 ft-lb.

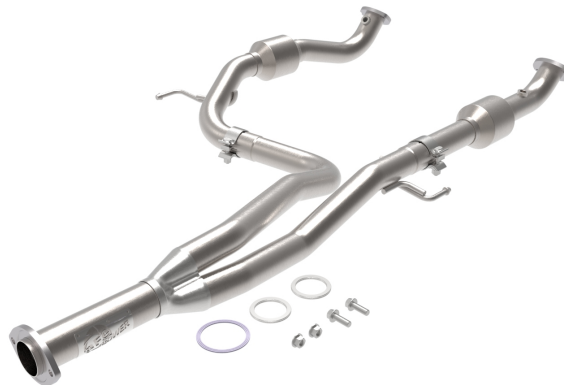



INSTALLATION INSTRUCTIONS

Twisted Steel Y-Pipe

48-46011-RC

MAKE: Toyota
MODEL: Tacoma
YEAR: 2016-2017
ENGINE: V6-3.5L

This system will NOT fit 4WD Tacoma models

1. **(Read Instructions prior to installation)** It is recommended to not fully tighten Y-pipe until it has been fully installed. Leave loose for adjustability.
2. Secure vehicle on jack stands (refer to your owner's manual for specified jack stand locations).
3. For faster installation, spread out the parts of the Y-pipe alongside your vehicle as shown in the diagram above.
4. Disconnect the negative battery terminal.
5. Unplug the all O2 sensor from the wire harness.
6. Remove the (x2) spring bolts passenger side Y-pipe.
7. Remove the (x2) nuts between the Y-pipe and exhaust manifolds on both passenger and driver sides.
8. Remove the bolts securing the Y-pipe to the exhaust. Remove the Y-pipe.
9. Remove O2 sensor from the stock exhaust Y-pipe and install onto the passenger side and driver side aFe POWER Y-pipes.
10. Install the driver and passenger side aFe POWER Y-pipes onto the aFe POWER Collector Assembly using supplied band clamps but do not fully tighten.
11. Install both passenger and driver side aFe POWER Y-pipes onto the OE manifolds using the supplied crush gaskets and the original 14mm nuts but do not tighten.
12. Install aFe POWER Collector Assembly side onto OE exhaust system using supplied gaskets, nuts, and bolts and tighten.
13. Start from the front of the aFe POWER Twisted Steel Y-pipe system and tighten all hardware.
14. Re-plug all O2 sensors.
15. Reconnect connect the battery.
16. The installation of your aFe POWER Twisted Steel Y-pipe is now complete. It is recommended to re-tighten all clamps and hardware 50-100 miles after installation.