



INSTALLATION INSTRUCTIONS

4" DPF-Back Dual Exhaust

MAKE: Ford
 MODEL: F-250/350
 YEAR: 2015-2016
 ENGINE: V8-6.7L(td)

49-43122-P
 49-43122-B

Fits Wheelbases: 141.8", 156.2", 158", 172.4"

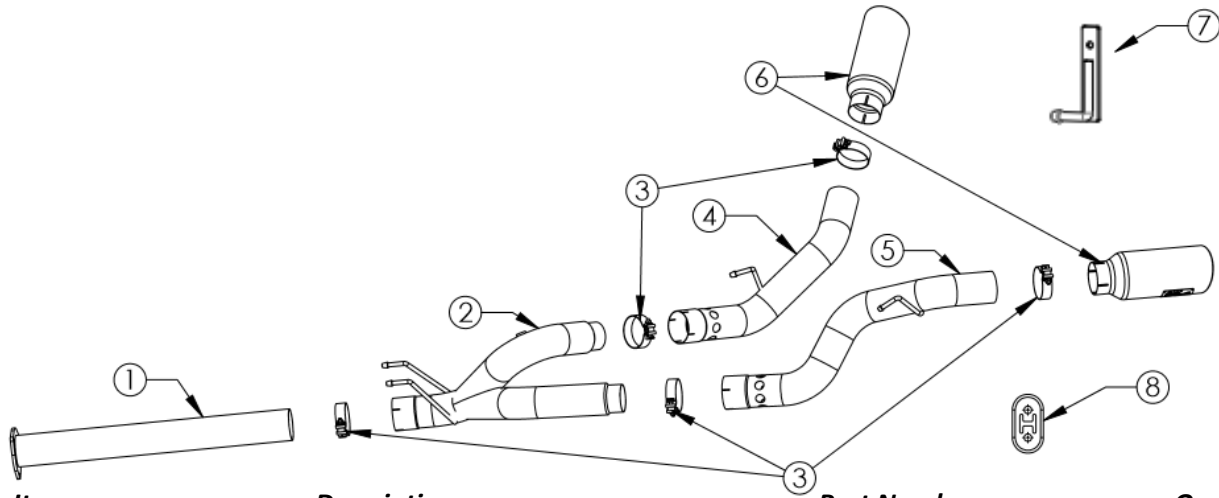

| Item | Description | Part Number | Quantity |
|------|---|-----------------------------|----------|
| 1 | S/A Mid-Pipe | 05-44978 | 1 |
| 2 | S/A Over-Axle Collector | 05-244059 | 1 |
| 3 | 4" Band Clamp | 05-41172 | 5 |
| 4 | S/A Tail Pipe Right | 05-44981 | 1 |
| 5 | S/A Tail Pipe Left | 05-44980 | 1 |
| 6 | EXH Tip 4 In x 6 Out x 15L Dual Bolt-On | 49T40606-B15 / 49T40606-P15 | 1 |
| 7 | Hanger Bracket | 05-46113 | 1 |
| 8 | Exhaust Isolation Mount | 05-46050 | 1 |

aFe POWER recommends professional installation on this product. Thoroughly inspect the aFe POWER exhaust system to make sure there is no damage from shipping (if damage is noted, immediately contact aFe POWER customer service). Allow time for your vehicle to cool down prior to installation. When working on your vehicle proceed with caution. Wear protective safety equipment; eye goggles and gloves to ensure a safe installation.

Install band clamps to proper torque specifications of 40-45 ft-lb.





INSTALLATION INSTRUCTIONS

4" DPF-Back Dual Exhaust

MAKE: Ford
MODEL: F-250/350
YEAR: 2015-2016
ENGINE: V8-6.7L(td)

49-43122-P
49-43122-B

Fits Wheelbases: 141.8", 156.2", 158", 172.4"

1. **(Read instructions prior to installation.)** It is recommended to not fully tighten the exhaust until it has been fully installed. Leave loose for adjustability.
2. For faster installation, spread out the parts of the exhaust alongside your vehicle as shown in the diagram above.
3. Secure the stock exhaust with jack/stands.
4. Unplug the particulate matter sensor from the wire harness.
5. Remove the (x3) 15mm bolts securing the DPF flange.
6. Remove the stock exhaust from hangers.
7. Install the Mid-pipe using original gasket and supplied hardware. NOTE: C/C Short bed (156.2" WB), S/C short bed (141.8" WB) and S/C Long Bed (158" WB) will require the mid-pipe be cut to length. Measure from the end of the tube. Please make sure to measure twice, before you cut! Crew cab long bed will use the mid-pipe as is.

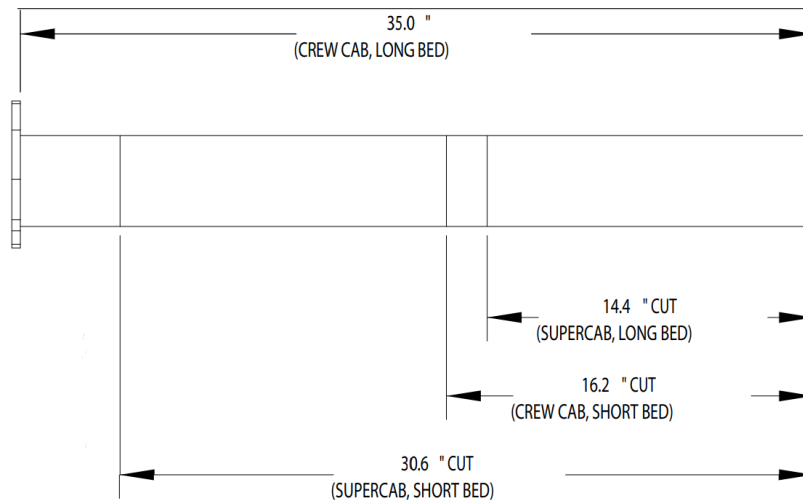

8. Install over-axle collector into mid-pipe. Do not tighten 4" band clamp and Slip Hangers in OE rubber Isolation mounts
9. Install right, tail pipe into position, Slip Hanger in OE rubber Isolation mount. Start from the front of the aFe exhaust system and evenly tighten all clamps and fasteners.
10. Place right side tip at desired position with aFe badge logo facing the rear of truck. Slightly tighten tip.
11. Install hanger bracket to the frame. Fully tighten the bracket in place.
12. Install left, tail pipe into position. Slip Hanger in OE rubber Isolation mount.
13. Place left side tip at desired position with aFe badge logo facing the rear of truck. Slightly tighten tip.
14. Ensure that all the components of the aFe POWER exhaust system are aligned and are at a safe clearance from all wires, hoses, brake lines, body parts, and tires.
15. Start from the front of the aFe exhaust system and evenly tighten all clamps and fasteners.
16. Re-plug particulate matter sensor.
17. Start the vehicle and check for any leaks. If any leaks are found, determine cause and repair as necessary.
18. It is recommended to re-tighten all clamps and hardware after 50-100 miles.