

## MOMENTUM<sup>HD</sup>

**advanced FLOW engineering** Cold Air Intake System

### Instruction Manual P/N: 50-70056D / 50-70056T

Make: Chevrolet	Model: Silverado 2500HD	Year: 2020-2024	Engine: V8-6.6L (td) L5P
Make: Chevrolet	Model: Silverado 3500HD	Year: 2020-2024	Engine: V8-6.6L (td) L5P
Make: GMC	Model: Sierra 2500HD	Year: 2020-2024	Engine: V8-6.6L (td) L5P
Make: GMC	Model: Sierra 3500HD	Year: 2020-2024	Engine: V8-6.6L (td) L5P



- Please read the entire instruction manual before proceeding.
- Ensure all components listed are present.
- For technical support please call 951-493-7185.
- Ensure you have all necessary tools before proceeding.
- Do not attempt to work on your vehicle when the engine is hot.
- Retain factory parts for future use.

Label	Qty.	Description	Part Number
A1	1	Air Filter (Pro 10R)	20-91147
A2	1	Air Filter (Pro DRY S)	21-91147
B	1	Tube	05-5070056B1
C	1	Housing	05-5070056B2
D	1	Coupling, Silicone Elbow Rdr: 100mm x 108mm 17 Deg	05-01420
E	1	Clamp, T-bolt (4-1/16" - 4-3/8")	03-50262
F	1	Clamp, T-bolt (4-5/16" - 4-5/8")	03-50499
G	1	Clamp, T-bolt (8-5/16" - 8-5/8")	03-50267
H	2	Screw, Torx: M4x8mm	03-50491
J	1	Plug, Silicone	05-01429
K	1	Seal, Inlet	05-01562
M	1	MAF Sensor Extension Harness*	05-70047

\* Use on 2024+ vehicles only.

**Installation will require the following tools:**

T20 Torx driver, 8mm nut driver, 10mm, 11mm & 13mm deep sockets and driver, 10mm wrench

Warranty information available at <https://afepower.com/contact#warranty>.

**Emissions Disclaimer:** This product is not currently CARB exempt and is not available for purchase in California or for use on any vehicle registered with the California Department of Motor Vehicles.

**IMPORTANT:** The Air Filter Life System needs to be reset to 100% and then disabled. Follow your owner’s manual procedure titled “How to Reset the Engine Air Filter Life System” then disable the system entirely. Failure to disable the system may prompt a persisting “Check Engine Air Filter System” message.

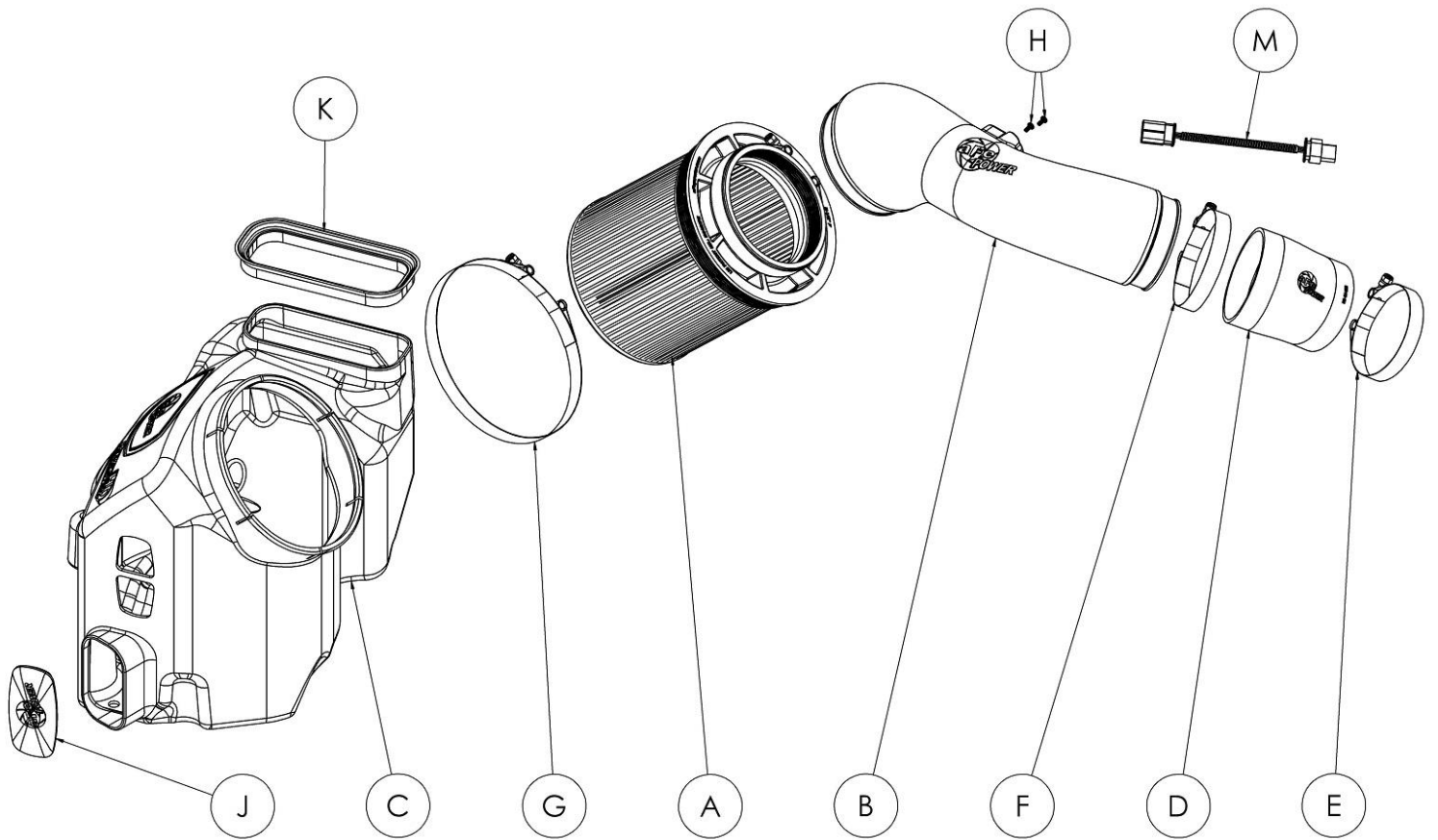
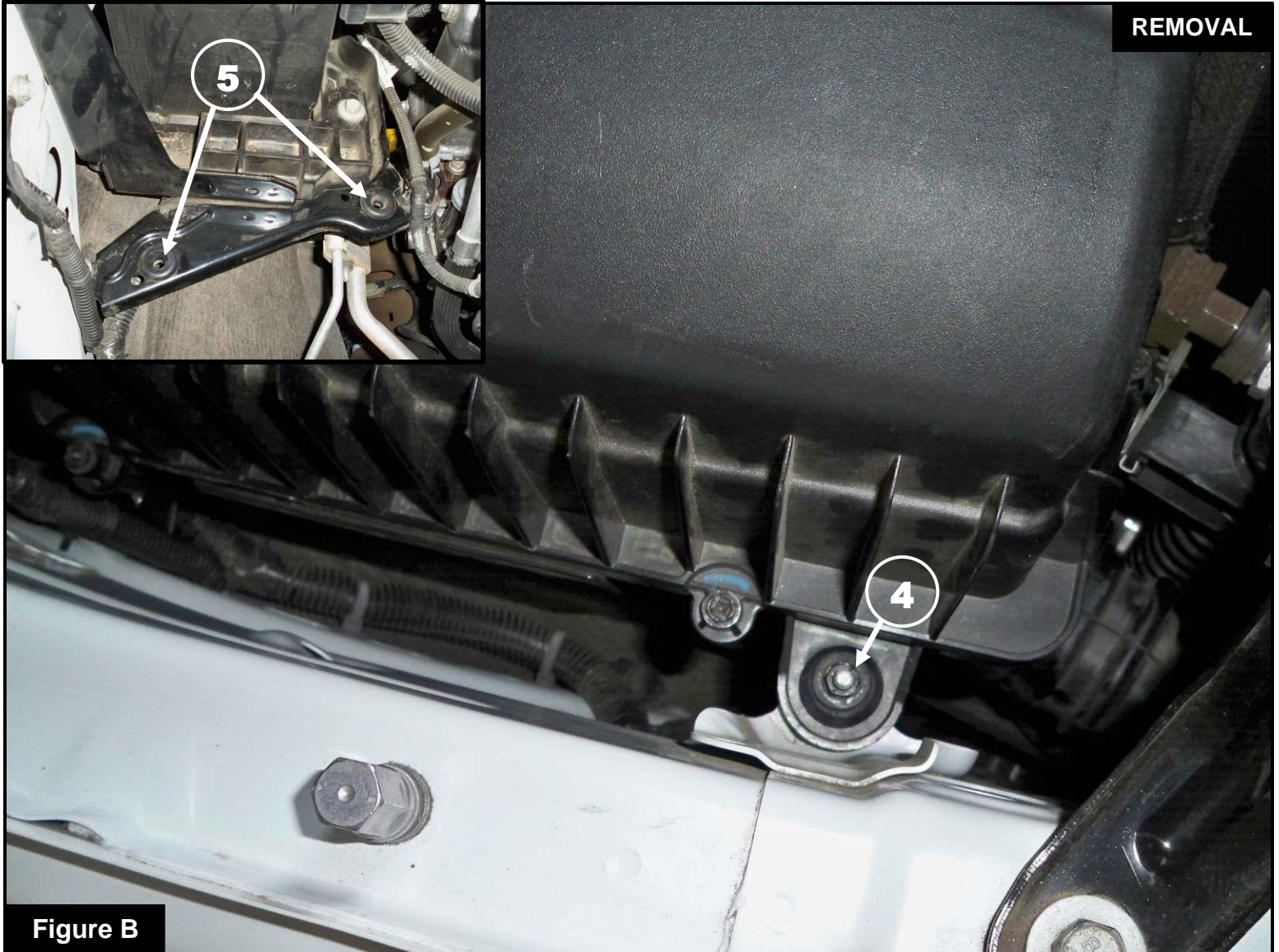

**Figure A****Refer to Figure A for Steps 1-3**

Step 1: Disconnect the Mass Air Flow (MAF) sensor ①.

Step 2: Using an 8mm nut driver, loosen the hose clamps ② at the factory airbox and the turbo coupling.

Step 3: Remove the factory intake tube ③.

**Figure B****Refer to Figure B for Steps 4-5**

Step 4: Using a 10mm deep socket and driver, remove the nut (4) holding the factory airbox to the fender and set the nut aside for later use.

Step 5: Remove the factory airbox by pulling it straight up from its mounting grommets. If the grommets (5) are pulled out with the factory airbox, remove them and put them back on the bracket holes.



Figure C

**Refer to Figure C for Step 6**

Step 6: Remove the metal insert and grommet ⑥ from the factory airbox and install them into the aFe POWER housing.



### **Refer to Figure D for Steps 7-9**

Step 7: Install the aFe POWER housing on to vehicle. Make sure the mounting pins are fully seated in the mounting grommets.

Step 8: From the inside of the aFe POWER housing, use a 10mm wrench to reinstall and tighten the nut (7) removed in Step 4.

Step 9: Make sure the air inlet scoop (8) is inside the front opening of the aFe POWER housing.



Figure E

**Refer to Figure E for Steps 10-11**

Step 10: Slide the large T-Bolt clamp ⑨ over the air filter opening on the aFe POWER housing.

Step 11: Slide the aFe POWER filter with clamp into the housing. Do not tighten the clamps.

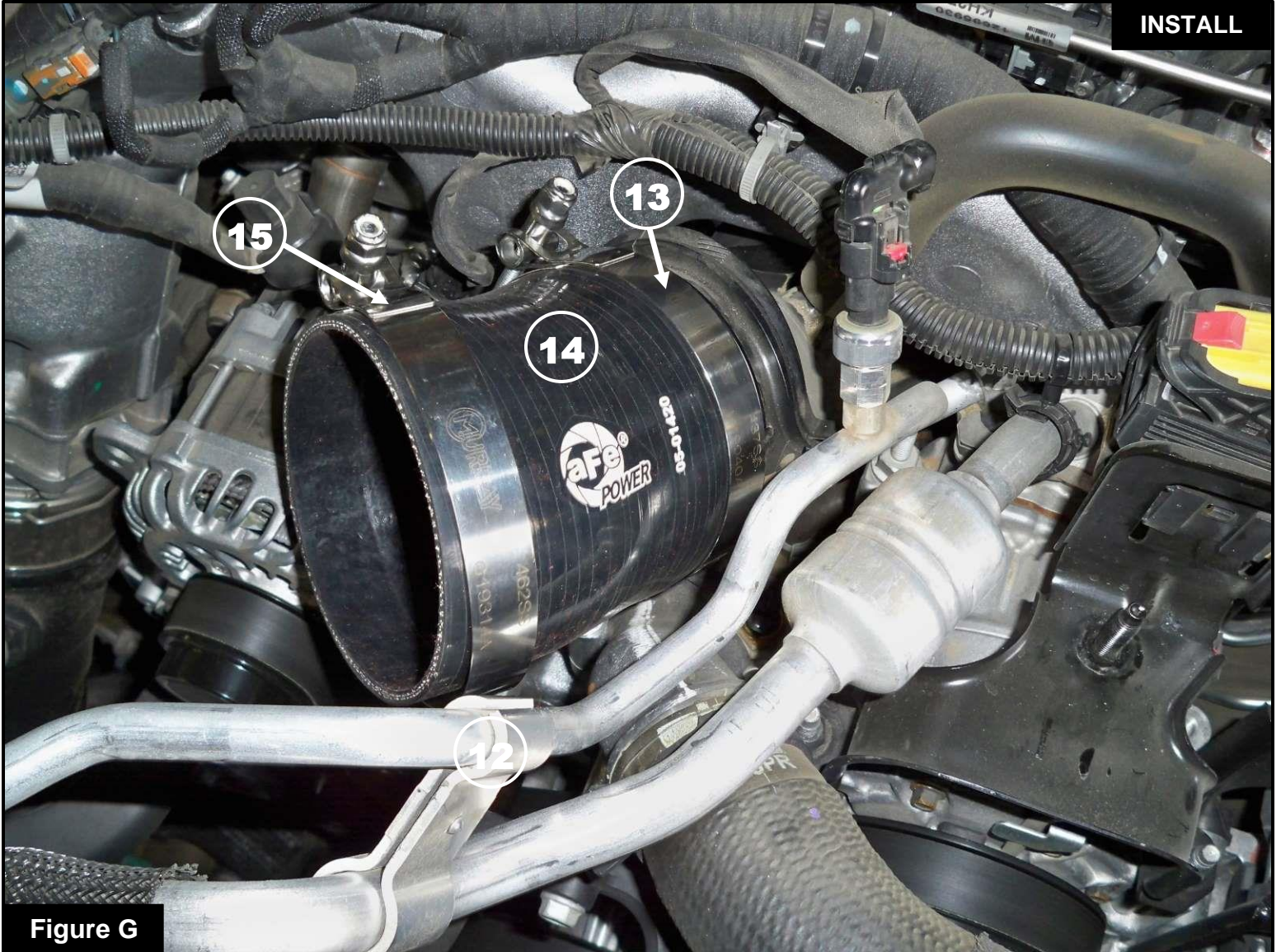



**Figure F**

### Refer to Figure F for Step 12

Step 12: If you wish to remove the resonator (10), loosen the clamp (11) at the turbo inlet with an 8mm nut driver. Using a 13mm deep socket, extension and driver, remove the nut (12) holding the resonator. Remove the resonator with the stock coupling.

**Note:** If you wish to keep the resonator skip to step 14 and reuse the factory coupling.

**Figure G****Refer to Figure G for Step 13**

Step 13: If the resonator is removed, install the supplied TB437SS clamp (13), coupling (14) and TB462SS clamp (15). Do not tighten the clamps.

**Figure H****Refer to Figure H for Step 14**

Step 14: Using a T20 Torx driver, remove the MAF sensor ①6 from the factory airbox and install it on the aFe POWER intake tube using the supplied M4 screws.



Figure I

**Refer to Figure I for Steps 15-16**

Step 15: Install the aFe POWER intake tube into the vehicle. Slide the tube into the coupling first, then into the air filter.

Step 16: Align the coupling, intake tube and clamps correctly, then using a 11mm deep socket and driver tighten all the clamps ⑰.



Figure J

**Refer to Figure J for Steps 17**

Step 17: Reconnect the MAF sensor to the harness. For 2024+ vehicle, use the provided MAF sensor extension harness.



Figure K

**Refer to Figure K for Steps 18-20**

Step 18: Install the inlet seal (18) to the top inlet of the aFe POWER housing.

Step 19: Use the provided plug (19) to close the additional air inlet if you want to completely seal the housing. Best performance gain is obtained by having more air flow (no plug).

Step 20: Check all the components are tight and secure. Your installation is now complete. Thank you for choosing aFe POWER!

**NOTE: Check all bolts, clamps, and connectors after 100-200 miles.**



**Page left blank intentionally**



***advanced FLOW engineering, inc.***

Corona, CA 92879

<https://afepower.com/contact>