

## ***advanced FLOW engineering***

Cold Air Intake System

### **Instruction Manual** P/N: 50-72205R / 50-72205D

|                    |  |                        |                            |
|--------------------|--|------------------------|----------------------------|
| <b>Make:</b> Dodge | <b>Model:</b> Challenger SRT Hellcat       | <b>Year:</b> 2017-2018 | <b>Engine:</b> V8-6.2L(sc) |
| <b>Make:</b> Dodge | <b>Model:</b> Charger SRT Hellcat          | <b>Year:</b> 2017-2020 | <b>Engine:</b> V8-6.2L(sc) |
| <b>Make:</b> Dodge | <b>Model:</b> Charger SRT Hellcat Widebody | <b>Year:</b> 2020-2023 | <b>Engine:</b> V8-6.2L(sc) |



- Please read the entire instruction manual before proceeding.
- Ensure all components listed are present.
- If you are missing any of the components, call customer support at 951-493-7185.
- Ensure you have all necessary tools before proceeding.
- Do not attempt to work on your vehicle when the engine is hot.
- Retain factory parts for future use.

| Label | Qty. | Description  | Part Number |
|-------|------|--|-------------|
| A1    | 1    | Air Filter (Pro 5R)                                      | 24-91101    |
| A2    | 1    | Air Filter (Pro DRY S)                                   | 21-91101    |
| B     | 1    | Tube   | 05-72205B1  |
| C     | 1    | Housing  | 05-72201B2  |
| D     | 1    | Clamp, T-bolt (4-9/16" - 4-7/8") (SS)                    | 03-50319    |
| E     | 1    | Clamp, T-Bolt (4-1/8" – 4-1/2") (SS)                     | 03-50262    |
| F     | 1    | Seal, Trim: 3/4" Bulb (21" Inches)                       | 05-01507    |
| G     | 1    | Coupling, Silicone Bellow                                | 05-01495    |
| H     | 1    | Grommet, Rubber  | 03-50167    |
| I     | 1    | Fitting, Air temp sensor                                 | 05-01454    |
| J     | 2    | Spring Clamp, 15/16" Hose (For 19 and Up Models Only)    | 03-50646    |
| K     | 1    | Silicone Hose 1/2" ID (20") (For 19 and Up Models Only)  | 05-01396    |
| L     | 1    | Elbow Fitting (For 19 and Up Only)                       | 03-50165    |
| M     | 1    | Easy-install Snap-Grip Clamp (For 19 and Up Models Only) | 03-50648    |

**Installation will require the following tools:**

8mm and 11mm nut driver or socket, flat screwdriver, blade and pliers.

Warranty Information available at: <https://afepower.com/contact#warranty>

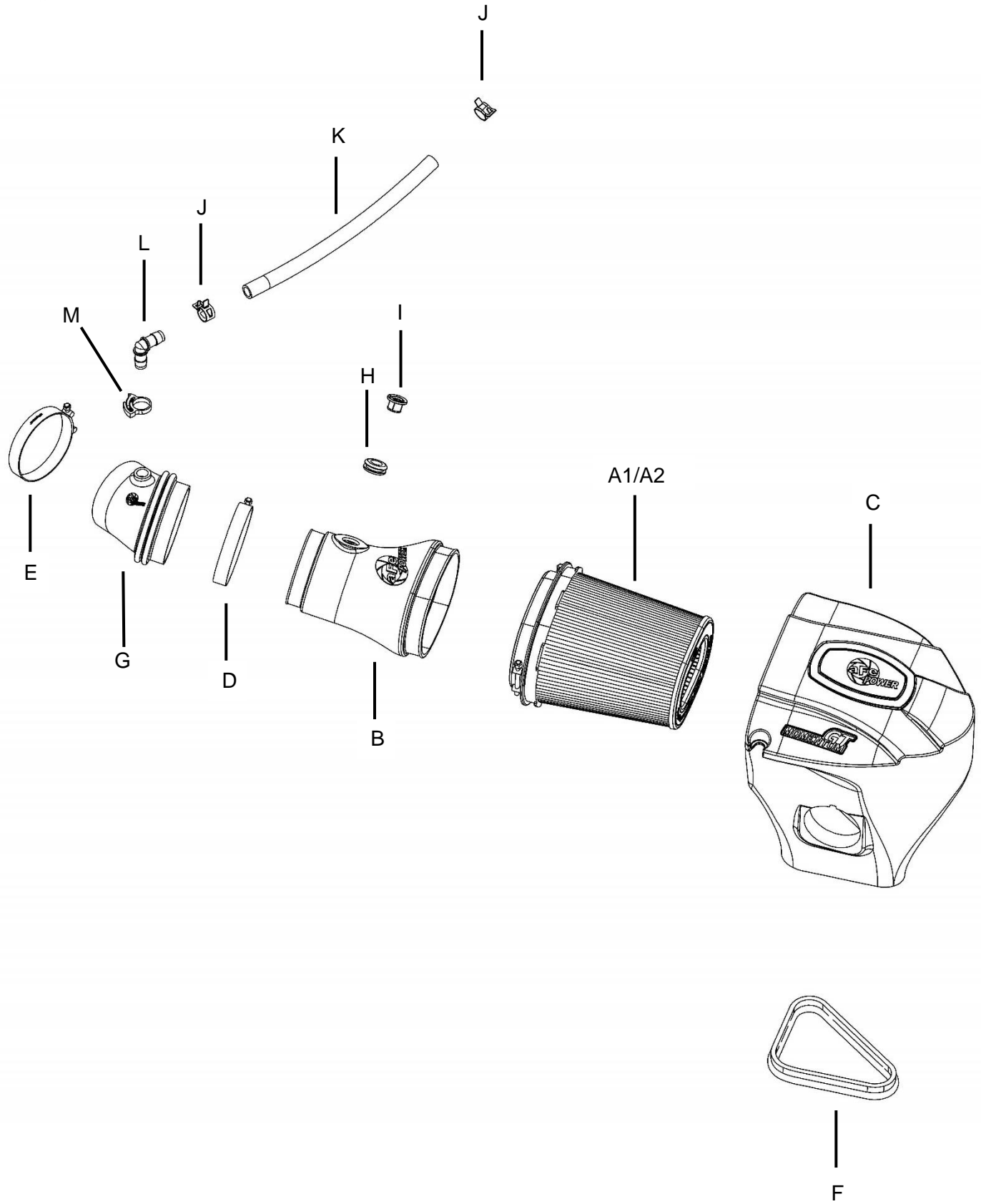

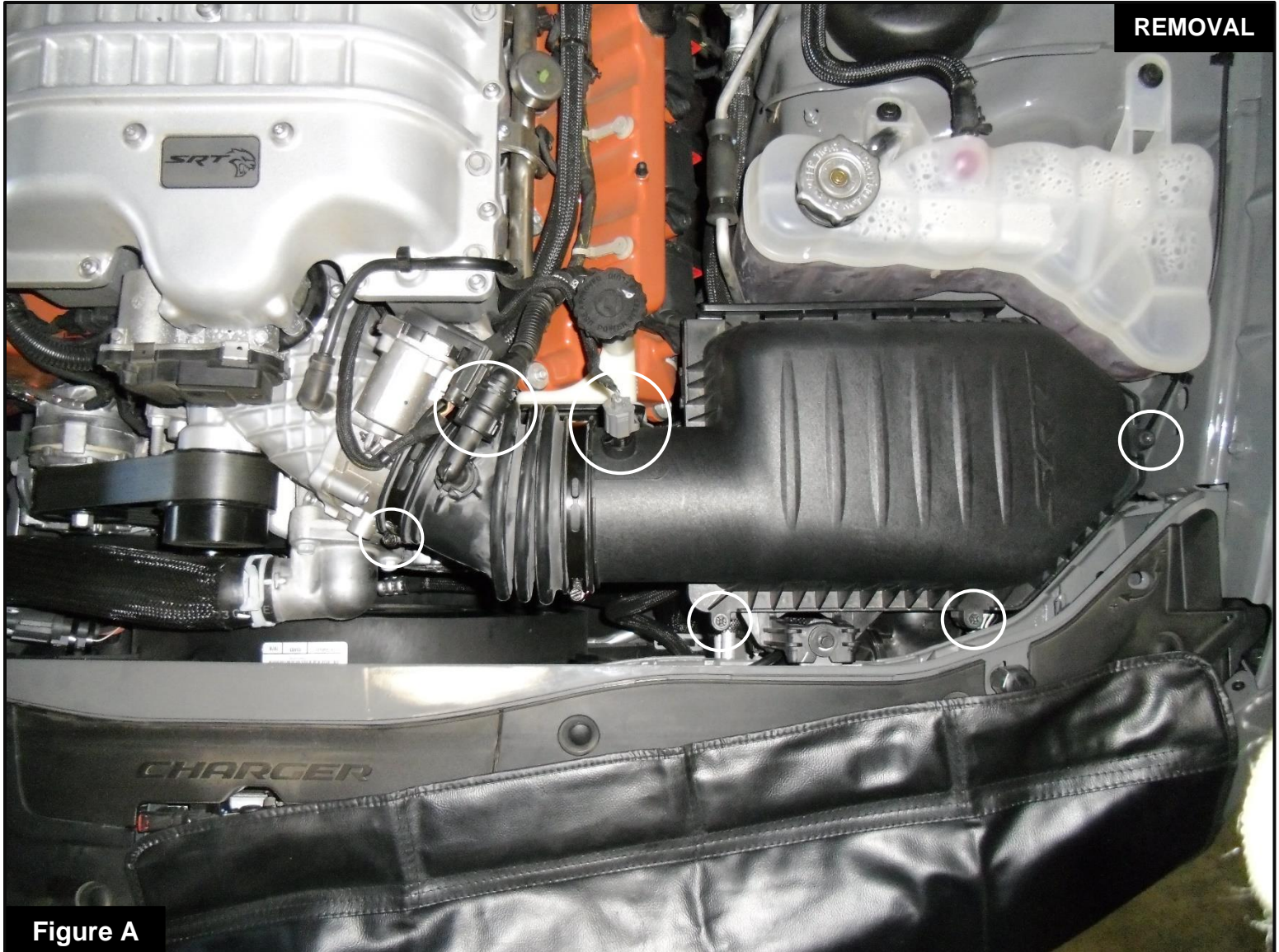

Figure A

**Refer to Figure A for Steps 1-4:**

Step 1: Disconnect the temperature sensor from the engine harness.

Step 2: **(For 17-18 Models ONLY)** Disconnect the 90-degree fitting from the PCV hose.

Step 3: Loosen clamp at the throttle body.

Step 4: Loosen the 3 screws securing the upper portion of the airbox to the lower portion.



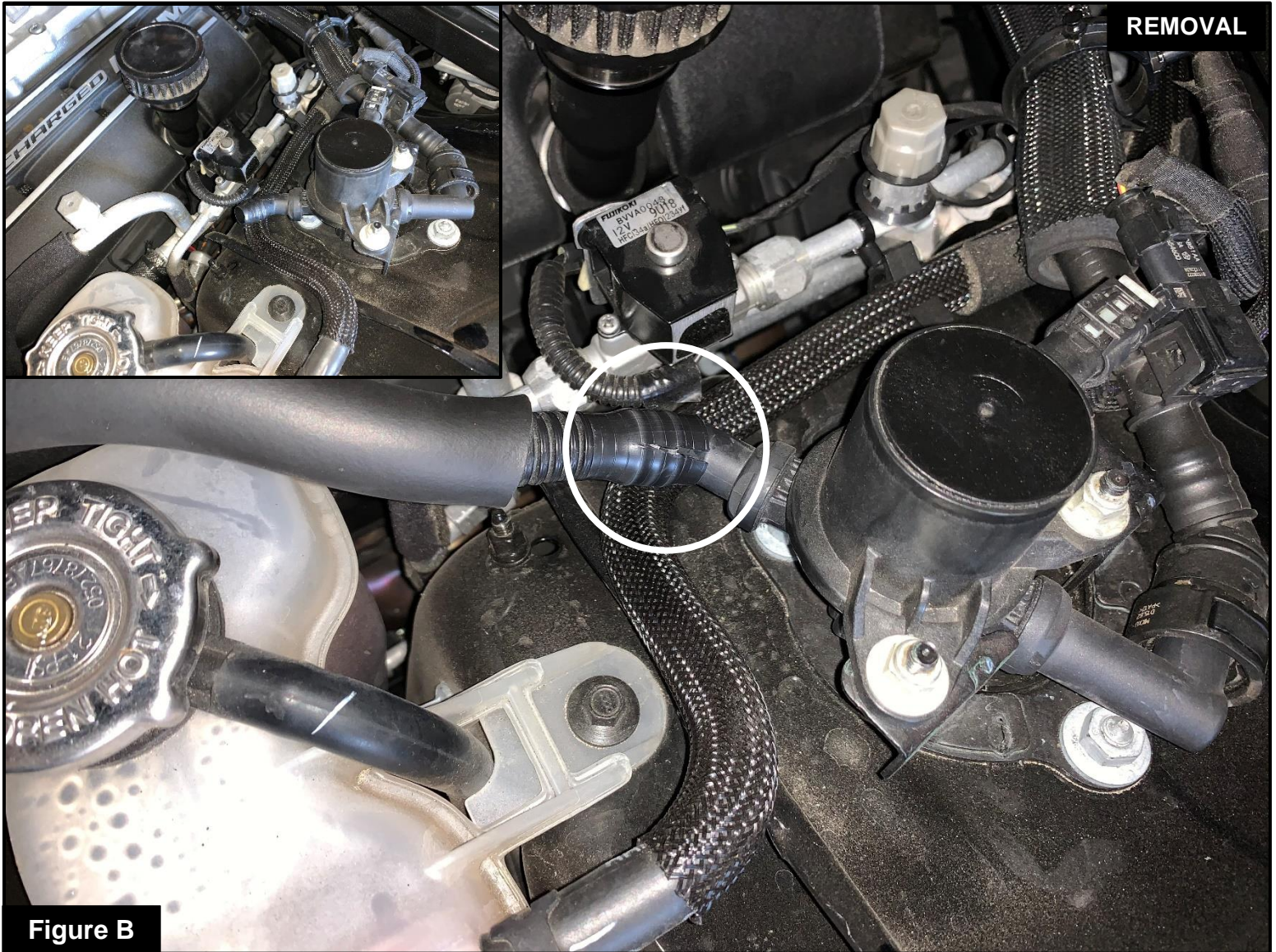

**Refer to Figure B for Steps 5-7:**

Step 5: **(For 19 and Up models ONLY)** Slice the plastic line connected to MUA system. Try to make the cut as clean as possible, if you ever need to reinstall the factory intake in the future. We suggest to use heat-shrink sleeve to cover the cut if needed.

Step 6: **(For 19 and Up models ONLY)** Disconnect the plastic hose from the MUA system. A silicone hose is provided to connect the aFe POWER tube to the MUA system.

Step 7: Remove the upper portion of the factory airbox and the flat panel air filter.



**Figure C****Refer to Figure C for Steps 8-10:**

Step 8: Using an 8mm nut driver, Remove the screw securing the factory airbox. This screw will be reused to secure the aFe POWER housing.

Step 9: **(For Challenger Models ONLY)** Remove the lower part of the factory airbox and inlet duct as one piece.

Step 10: **(For Charger Models ONLY)** Disconnect the inlet duct from the factory airbox and pull the lower part of the airbox outside of the vehicle. (The inlet duct is not removable on Charger models)



Figure D

**Refer to Figure D for Step 11:**

Step 11: Make sure the factory mounting grommet is installed correctly into the hole. If the grommet stayed with the lower portion of the factory airbox, reinstall it into the hole on the wheel cover.



**Figure E****Refer to Figure E for Steps 12-15:**

Step 12: Transfer the metal sleeve and grommet from the factory airbox to the aFe POWER airbox.

Step 13: Install the provided trim seal around the bottom edge of the aFe POWER airbox.

Step 14: Slide the air filter inside the aFe POWER housing until it locks into place. Install the clamp on the filter flange. Do not tighten clamp at this time.

Step 15: **(For Challenger models ONLY)** Transfer the inlet duct from the lower portion of the factory airbox to the aFe POWER air box.



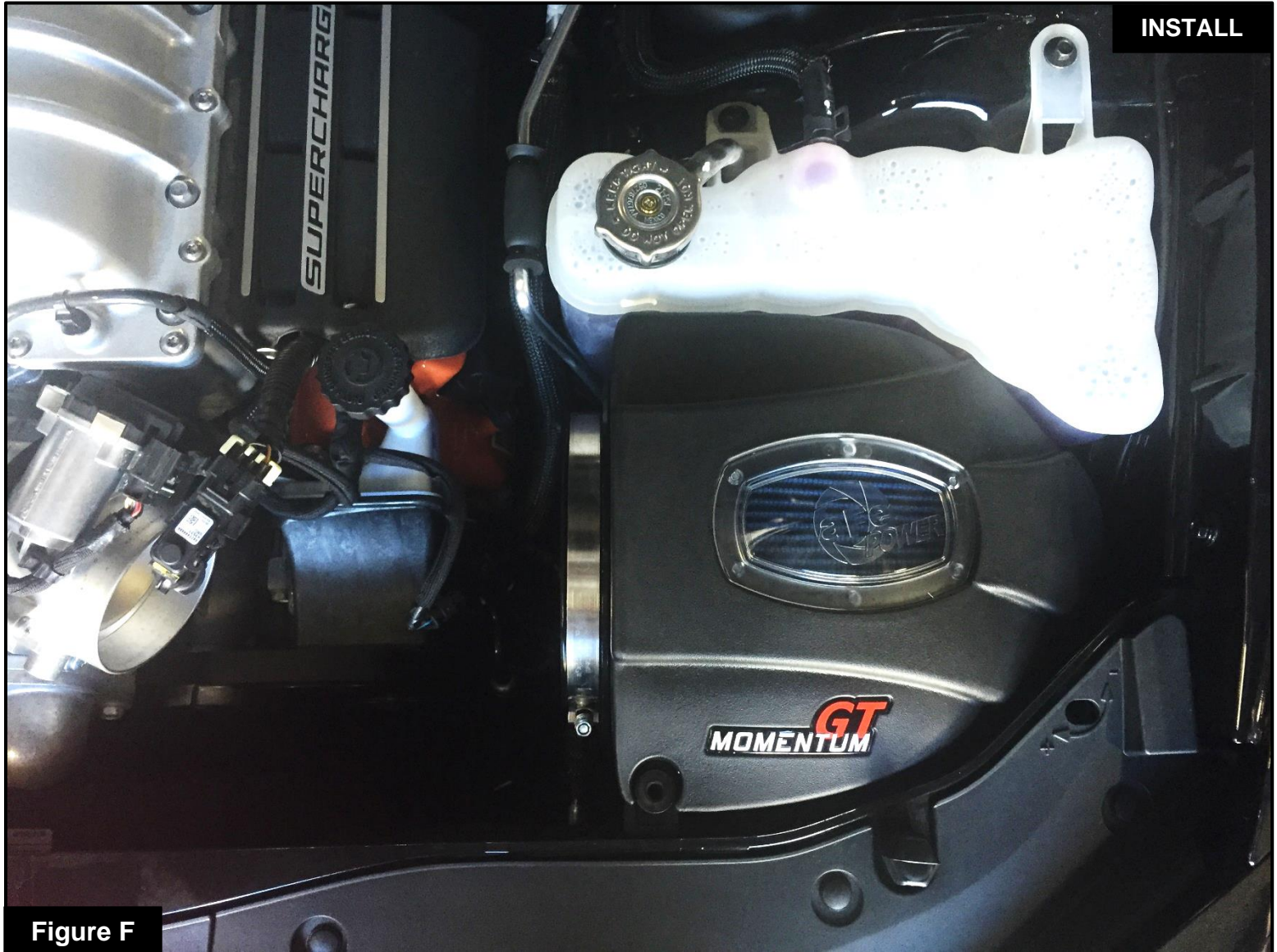

Figure F

**Refer to Figure F for Step 16:**

Step 16: Install the aFe POWER airbox into the vehicle. Do not install the 8mm bolt yet. **(For Charger models ONLY)** Connect the factory air inlet duct while installing the housing in.

**Figure G****Refer to Figure G for Steps 17-18:**

Step 17: Remove the temperature sensor from factory airbox. Install the provided grommet into the hole on the aFe POWER tube then press in the plastic fitting. Make sure to clock the fitting with the tab facing like Figure G.

Step 18: Secure the temperature sensor into the plastic fitting by turning clockwise.





**Refer to Figure H for Step 19:**

Step 19: Install the coupling on the throttle body. Install the clamp closest to the throttle body only, do not tighten clamp yet.





Figure I

**Refer to Figure I for Steps 20-24:**

- Step 20: Install the aFe POWER intake tube, by sliding the tube into the filter first and then the coupling.
- Step 21: Open the remaining T-bolt clamp and install it over the coupling and tube end.
- Step 22: Make sure the coupling, tube and air filter are aligned correctly, then tighten all clamps.
- Step 23: Reinstall the screw removed at step 8 to secure the aFe POWER airbox.
- Step 24: Reconnect the temperature sensor harness.





**Refer to Figure J for Steps 25-26:**

Step 25: ( **For 17-18 models ONLY**) Remove the elbow fitting from the factory tube and press it into the aFe POWER coupling.

Step 26: ( **For 17-18 models ONLY**) Reconnect the elbow fitting to the factory hose.

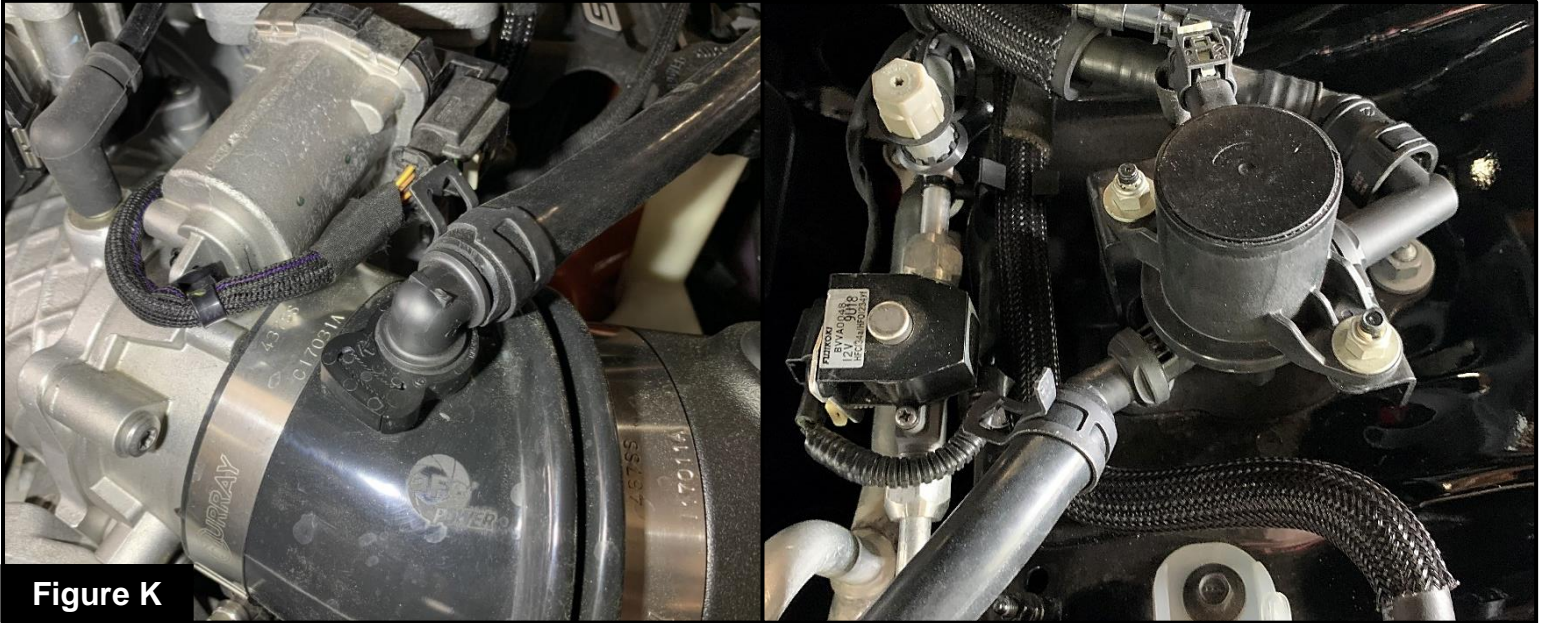
**Figure K**

**Refer to Figure K for Steps 27-28:**

**Step 27: (For 19 and Up Models ONLY)** Install the two spring clamps over the provided silicone hose (deep enough on the hose so you can still install a fitting into the hose). Press the 90 Degree elbow fitting into one end of the hose.

**Step 28: (For 19 and Up Models ONLY)** Place the Snap-Grip Clamp over the hole onto the coupling mounted to the throttle body then press in the 90 Degree elbow fitting into it. Connect the other end of the silicone hose to the MUA system. Move the spring clamps on the hose to secure the hose connections and close the Snap-Grip clamp using pliers to secure the 90 Degree fitting into the coupling.





Figure L

**Refer to Figure L for Step 29:**

Step 29: Verify all connections are secured. Your installation is now complete. Thank you for choosing aFe POWER!

**NOTE: Place enclosed CARB EO Sticker on or near the device on a smooth, clean surface.**

**EO identification label is required to pass the smog test inspection.**

**Check all screws, clamps, and connectors are secure after 100-200 miles.**



***advanced FLOW engineering, inc.***

Corona, CA 92879

<https://afepower.com/contact>