



# INSTALLATION INSTRUCTIONS

**MAKE:** Hyundai  
**MODEL:** Veloster Turbo  
**YEAR:** 2019-2021  
**ENGINE:** L4-1.6L

**Cat-Back Exhaust**

49-37011-P  
 49-37011-B  
 49-37011-L  
 49-37011-C

**NOTE: REQUIRES CUTTING**

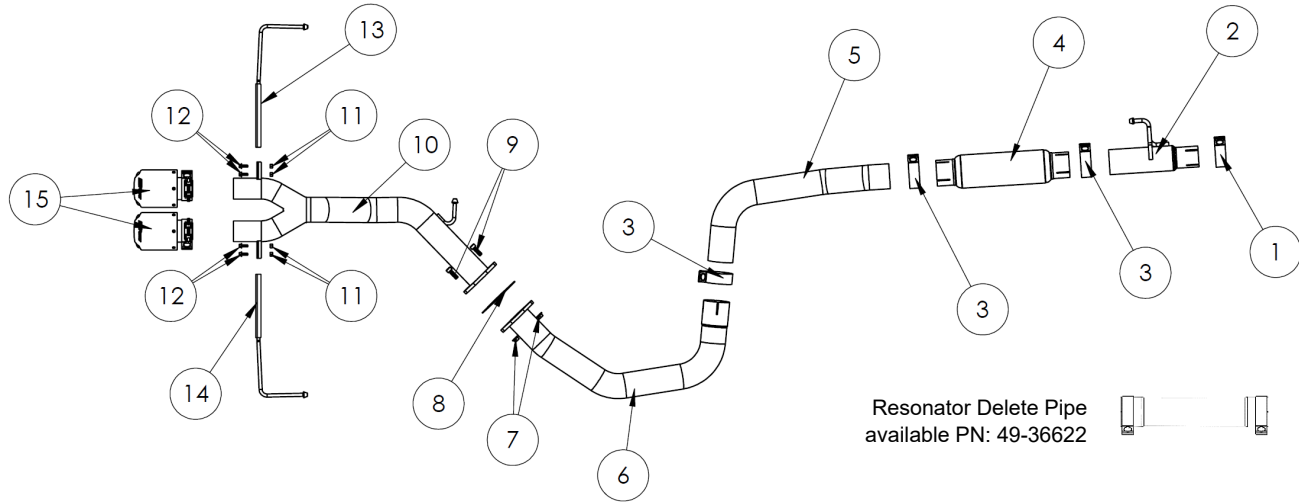

Resonator Delete Pipe  
 available PN: 49-36622



Item	Description	Part Number	Quantity
1	2-1/2" Band Clamp	05-41061	1
2	Front Pipe Assembly	05-145896	1
3	3" Band Clamp	05-41055	3
4	Resonator	05-145193	1
5	Mid-pipe 1	05-145897	1
6	Mid-pipe 2	05-145898	1
7	M10 Nut	03-50189	2
8	Gasket	05-46300	1
9	10mm Hex Head Cap Bolt	03-50452	2
10	Axle-Back Assembly	05-145899	1
11	1/4-20 Nylon Insert Locknut	03-50073	4
12	1/4-20 Serrated Hex Flange Screw	03-50100	4
13	Bracket Assembly, PS	05-46435	1
14	Bracket Assembly, DS	05-46436	1
15	4-1/2" Polished Clamp on Tips	49T25454-P07	2
	4-1/2" Black Clamp on Tips	49T25454-B07	
	4-1/2" Blue Flame Clamp on Tips	49T25454-L07	
	4-1/2" Carbon Clamp on Tips	49T25454-C07	

**aFe POWER recommends professional installation on this product.** Thoroughly inspect the aFe POWER exhaust system to make sure there is no damage from shipping (if damage is noted, immediately contact aFe POWER customer service). Allow time for your vehicle to cool down prior to installation. When working on your vehicle proceed with caution. Wear protective safety equipment; eye goggles and gloves to ensure a safe installation.

Install band clamps to proper torque specifications of 40-45 ft-lb.



## INSTALLATION INSTRUCTIONS

**MAKE:** Hyundai  
**MODEL:** Veloster Turbo  
**YEAR:** 2019-2021  
**ENGINE:** L4-1.6L

**Cat-Back Exhaust**

49-37011-P

49-37011-B

49-37011-L

49-37011-C

**NOTE: REQUIRES CUTTING**

1. **(Read instructions prior to installation.)** It is recommended to not fully tighten the exhaust until it has been fully installed. Leave loose for adjustability.
2. Secure vehicle on jack stands (refer to your manual for specified jack stand positions).
3. For faster installation, spread out the parts of the exhaust alongside your vehicle as shown in the diagram above.
4. Secure the stock exhaust with jack/stands.
5. Remove the mid pipe section by unbolting it in front of the rear catalytic converter, stock axle-back section, and removing it from the stock isolator mount.
6. Remove the Heat shield in-between the rear cat and the stock resonator. Mark 4" from the Back of the weld on the rear catalytic converter and the exhaust. **See reference images 1 and 2.**
7. Re-install the stock catalytic converter using the OE hardware.
8. Install the front pipe adaptor using the provided 2-1/2" clamp. Slide hanger into stock rubber isolator.
9. Install the resonator and mid-pipes 1 and 2 as shown in the diagram using the provided (x3) 3" band clamps.
10. Using the provided (x2) 10mm bolts, (x2) M10 nuts, and gasket, install the Takeda Axle-Back Assembly and slide hanger into the rubber isolation mount.
11. Install the driver and passenger side hanger bracket assemblies onto the Takeda Axle-Back Assembly using the supplied 1/4-20 hardware.
12. Install the clamp on tips and adjust to your liking, but do not tighten.
13. Ensure that all the components of the Takeda exhaust system are aligned and are at a safe clearance from all wires, hoses, brake lines, body parts, and tires.
14. Start from the front of the Takeda exhaust system and evenly tighten all clamps and fasteners.
15. Start the vehicle and check for any leaks. If any leaks are found, determine cause and repair as necessary.
16. Remove vehicle from jacks stands.
17. It is recommended to re-tighten all clamps and hardware after 50-100 miles.

