



# INSTALLATION INSTRUCTIONS

Cat-Back Exhaust

**MAKE:** Porsche  
**MODEL:** 911 Carrera (991)  
**YEAR:** 2012-2016  
**ENGINE:** H6-3.8L

49-36406-1P  
49-36406-1C  
49-36406-1B

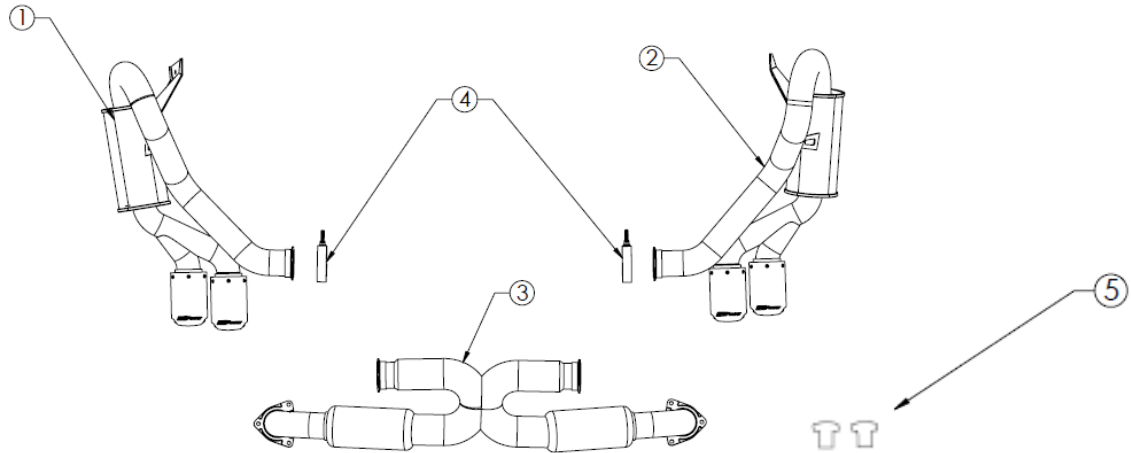

Item	Description	Part Number	Quantity
1	Left Side Muffler Pipe (Black)	05-145827B	1
	Left Side Muffler Pipe (Carbon)	05-145827C	
	Left Side Muffler Pipe (Polished)	05-145827P	
2	Right Side Muffler Pipe (Black)	05-145828B	1
	Right Side Muffler Pipe (Carbon)	05-145828C	
	Right Side Muffler Pipe (Polished)	05-145828P	
3	X-Pipe Assembly	05-145826	1
4	V-Band Clamp	05-410196	2
5	Plug, Tubing, 1/8"	03-50201	2

**aFe POWER recommends professional installation on this product.** Thoroughly inspect the aFe POWER exhaust system to make sure there is no damage from shipping (if damage is noted, immediately contact aFe POWER customer service). Allow time for your vehicle to cool down prior to installation. When working on your vehicle proceed with caution. Wear protective safety equipment; eye goggles and gloves to ensure a safe installation.

Install band clamps to proper torque specifications of 40-45 ft-lb.

Install V-band clamps with anti-seize lubricant and hand tighten only to torque specifications of 10-15 ft-lb.

- (Read instructions prior to installation.)** It is recommended to not fully tighten the exhaust until it has been fully installed. Leave loose for adjustability.
- Secure vehicle on jack stands (refer to your manual for specified jack stand positions).
- For faster installation, spread out the parts of the exhaust alongside your vehicle as shown in the diagram above.
- Secure the stock exhaust with jack/stands.
- Remove rear taillights and then the rear bumper cover.
- Remove left and right-side muffler bracket heat shields.
- Remove vacuum hoses off left and right-side exhaust valves.
- Remove OE exhaust system.
- OPTIONAL: Remove the rear muffler brace securing the OE muffler with band clamps.
- Using the (x2) supplied aFe POWER vacuum hose plugs, plug the OE vacuum hoses.
- Using the original nuts and gaskets (Replace if necessary) removed from step 7, install the aFe POWER X-Pipe and tighten to factory torque specs.
- Using the original nuts removed from step 8, install the left side aFe POWER Muffler section to the aFe POWER X-Pipe using the supplied V-band clamps and securing onto the chassis bracket but do not tighten.



## INSTALLATION INSTRUCTIONS

**MAKE:** Porsche  
**MODEL:** 911 Carrera (991)  
**YEAR:** 2012-2016  
**ENGINE:** H6-3.8L

## Cat-Back Exhaust

49-36406-1P  
49-36406-1C  
49-36406-1B

- 
13. Using the original nuts removed from step 8, install the right side aFe POWER Muffler section to the aFe POWER X-Pipe using the supplied V-band clamps and secure onto the chassis bracket but do not tighten.
  14. Secure the left and right-side muffler brackets using the original hardware removed from step 6 and tighten muffler brackets and V-band clamps.
  15. Secure the bumper cover using the original hardware removed from step 3 and tighten.
  16. Secure the rear taillights using the original hardware removed from step 3 and tighten.
  17. Ensure that all the components of the aFe POWER exhaust system are aligned and are at a safe clearance from all wires, hoses, brake lines, body parts, and tires.
  18. Start the vehicle and check for any leaks. If any leaks are found, determine cause and repair as necessary.
  19. Remove vehicle from jacks stands.
  20. It is recommended to re-tighten all clamps and hardware after 50-100 miles.