



INSTALLATION INSTRUCTIONS

Twisted Steel Downpipes

48-46012-HC (w/Cats)

MAKE: Toyota
MODEL: Tacoma
YEAR: 2016-2018
ENGINE: V6-3.5L

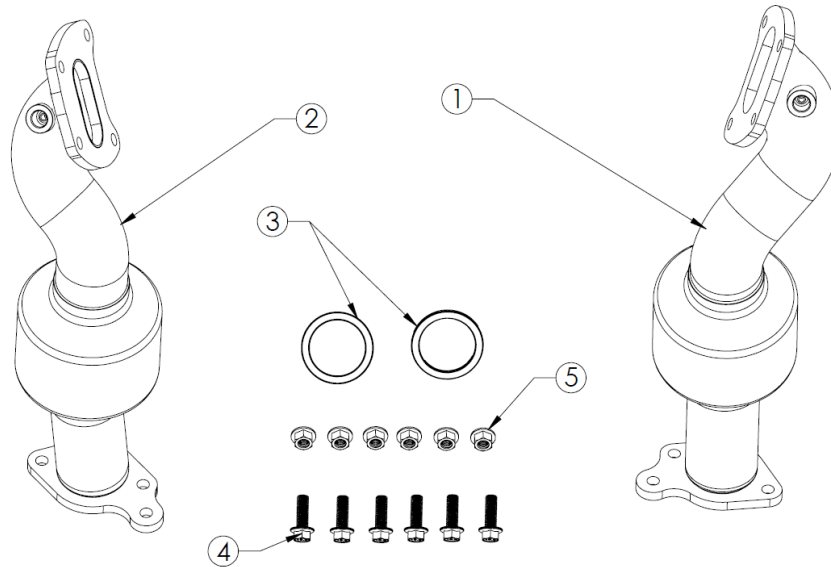

| Item | Description | Part Number | Quantity |
|------|------------------------------------|-------------|----------|
| 1 | Passenger Side Downpipe (with CAT) | 05-144804 | 1 |
| 2 | Driver Side Downpipe (with CAT) | 05-144805 | 1 |
| 3 | Crush Gasket | 05-60366 | 2 |
| 4 | 10mm x 1.25 x 35mm Bolt | 03-50401 | 6 |
| 5 | 10mm x 1.25 Nut | 03-50400 | 6 |

aFe POWER recommends professional installation on this product. Thoroughly inspect the aFe POWER exhaust system to make sure there is no damage from shipping (if damage is noted, immediately contact aFe POWER customer service). Allow time for your vehicle to cool down prior to installation. When working on your vehicle proceed with caution. Wear protective safety equipment; eye goggles and gloves to ensure a safe installation.

Install band clamps to proper torque specifications of 40-45 ft-lb.

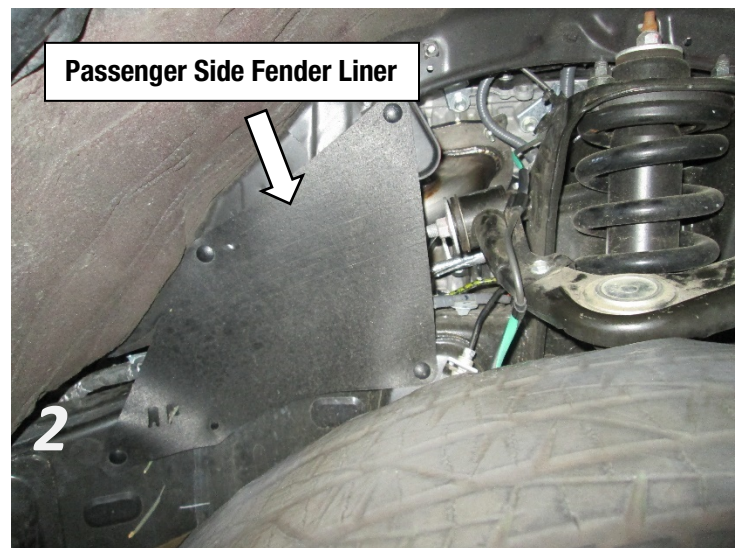
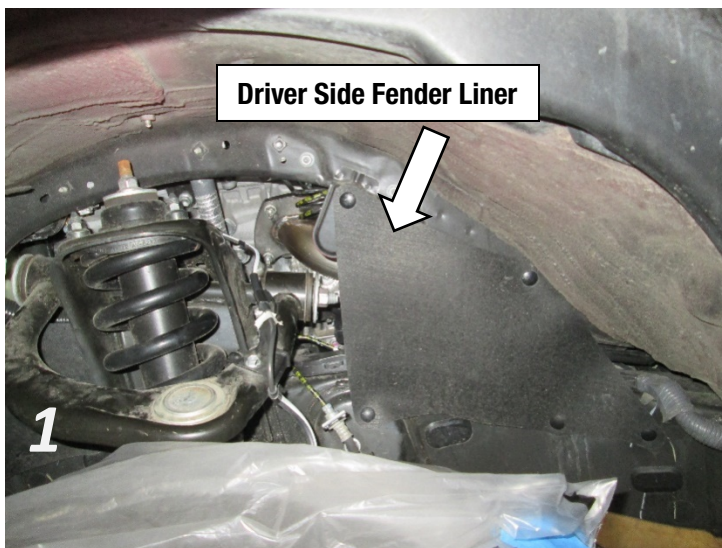



INSTALLATION INSTRUCTIONS

Twisted Steel Downpipes

48-46012-HC (w/Cats)

MAKE: Toyota
MODEL: Tacoma
YEAR: 2016-2017
ENGINE: V6-3.5L

1. **(Read Instructions prior to installation)** It is recommended to not fully tighten the downpipes until it has been fully installed. Leave loose for adjustability.
2. Secure vehicle on jack stands (refer to your owner's manual for specified jack stand locations).
3. Disconnect the negative battery terminal.
4. Remove the driver and passenger side fenders liner. **See reference image 1 and 2.**
5. Unplug all O2 sensors from the wire harness.
6. Remove Y-pipe and passenger side catalytic converter.
7. Remove the driver and passenger side heatshields.
8. Remove the 14mm bolt on the passenger side exhaust manifold support bracket.
9. Loosen the (x2) 14mm bolts securing the passenger side support bracket to the engine block so that the bracket is loose, but do not remove the bolts.
10. Remove the (x4) nuts on the passenger side exhaust manifold and remove the exhaust manifold.
11. Remove the passenger side O2 sensor from the stock exhaust manifold and install onto the Passenger Side aFe POWER Down Pipe.
12. Install the Passenger Side aFe POWER Down Pipe using the original nuts (the original exhaust manifold gasket can be re-used if not damaged, replace if necessary) but do not tighten.
13. Reinstall the exhaust support bracket to the down pipe using the supplied nut and bolt. Make finger tight only at this time. Tighten all the nuts and bolts on the exhaust support bracket to engine block as well as the bolt on the support bracket to the aFe POWER Down Pipe.
14. Remove the 14mm bolt on the driver side exhaust manifold support bracket.
15. Loosen the (x2) 14mm bolts securing the driver side support bracket to the engine block, so the bracket is loose but do not remove the bolts.
16. Remove the (x4) nuts on the driver side exhaust manifold and remove the exhaust manifold.
17. Remove the driver side O2 sensor from the stock exhaust manifold and install on the Driver Side aFe POWER Down Pipe.
18. Install the Driver Side aFe POWER Down Pipe using the original nuts (the original exhaust manifold gasket can be re-used if not damaged, replace if necessary) but do not tighten.
19. Reinstall the passenger side catalytic converter and Y-pipe using the supplied gaskets, nuts, and bolts and tighten.
20. Reinstall spring bolts on Y-pipe to exhaust system and tighten.
21. Start from the top of the aFe POWER Twisted Steel Downpipes and tighten all hardware.
22. Re-plug remaining O2 sensors on rear catalytic converters.
23. Reinstall driver and passenger side fender liner.
24. Reconnect connect the battery.
25. The installation of your aFe POWER Twisted Steel Downpipes is now complete. It is recommended to re-tighten all clamps and hardware 50-100 miles after installation.