

MAKE: Hyundai
MODEL: Veloster N
YEAR: 2019-2022
ENGINE: L4-2.0L (t)

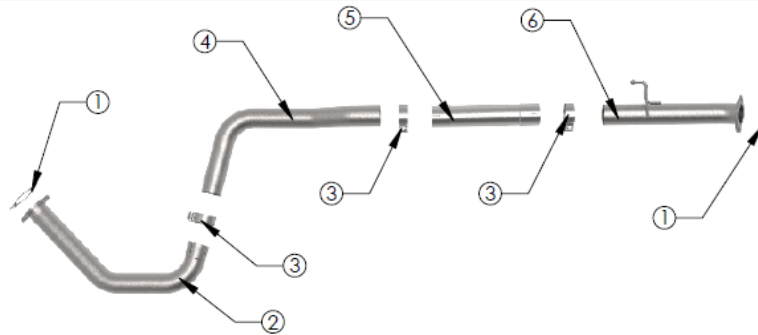

Item	Description	Part Number	Quantity
1	Gasket	05-46400	2
2	Mid-Pipe 2 Assembly	05-145773	1
3	3" Band Clamp	05-41055	3
4	Mid-Pipe 1	05-145772	1
5	Resonator Delete Pipe	05-145401	1
6	Front Pipe	05-145771	1

aFe POWER recommends professional installation on this product. Thoroughly inspect the aFe POWER exhaust system to make sure there is no damage from shipping (if damage is noted, immediately contact aFe POWER customer service). Allow time for your vehicle to cool down prior to installation. When working on your vehicle proceed with caution. Wear protective safety equipment; eye goggles and gloves to ensure a safe installation.

Install band clamps to proper torque specifications of 40-45 ft-lb.

- (Read instructions prior to installation.)** It is recommended to not fully tighten the exhaust until it has been fully installed. Leave loose for adjustability.
- Secure vehicle on jack stands (refer to your manual for specified jack stand positions).
- For faster installation, spread out the parts of the exhaust alongside your vehicle as shown in the diagram above.
- Secure the stock exhaust with jack/stands.
- Loosen the (x2) nuts securing the muffler assembly to the OE mid-pipe.
- Unplug the valve motor connector and put to the side as not to damage the connector.
- Remove the (x3) isolation mounts on the muffler assembly using hanger pliers or a pry bar.
- Remove the OE muffler assembly.
- Loosen the (x2) nuts securing the mid-pipe to the downpipe.
- Remove the (x1) isolation mount on the mid-pipe using hanger pliers or a pry bar and remove the OE mid-pipe.
- Using the provided gasket and the OE (x2) nuts, install the Takeda Race-pipe.
- Slide the hanger on the Takeda Race-pipe into the OE isolation mount.
- Install the Resonator Delete Pipe using the supplied (x2) 3" band clamp.
- Install the Takeda Mid-Pipe 1 using the provided 3" band clamp.
- Install the Takeda Mid-Pipe 2 Assembly using the provided 3" band clamp. Install the OE tailpipe using the provided hardware and gasket, then slide the hangers onto the OE isolation mounts.
- Ensure that all the components of the Takeda exhaust system are aligned and are at a safe clearance from all wires, hoses, brake lines, body parts, and tires.
- Start from the front of the Takeda exhaust system and evenly tighten all clamps and fasteners.
- Start the vehicle and check for any leaks. If any leaks are found, determine cause and repair as necessary.
- Remove vehicle from jacks stands.
- It is recommended to re-tighten all clamps and hardware after 50-100 miles