

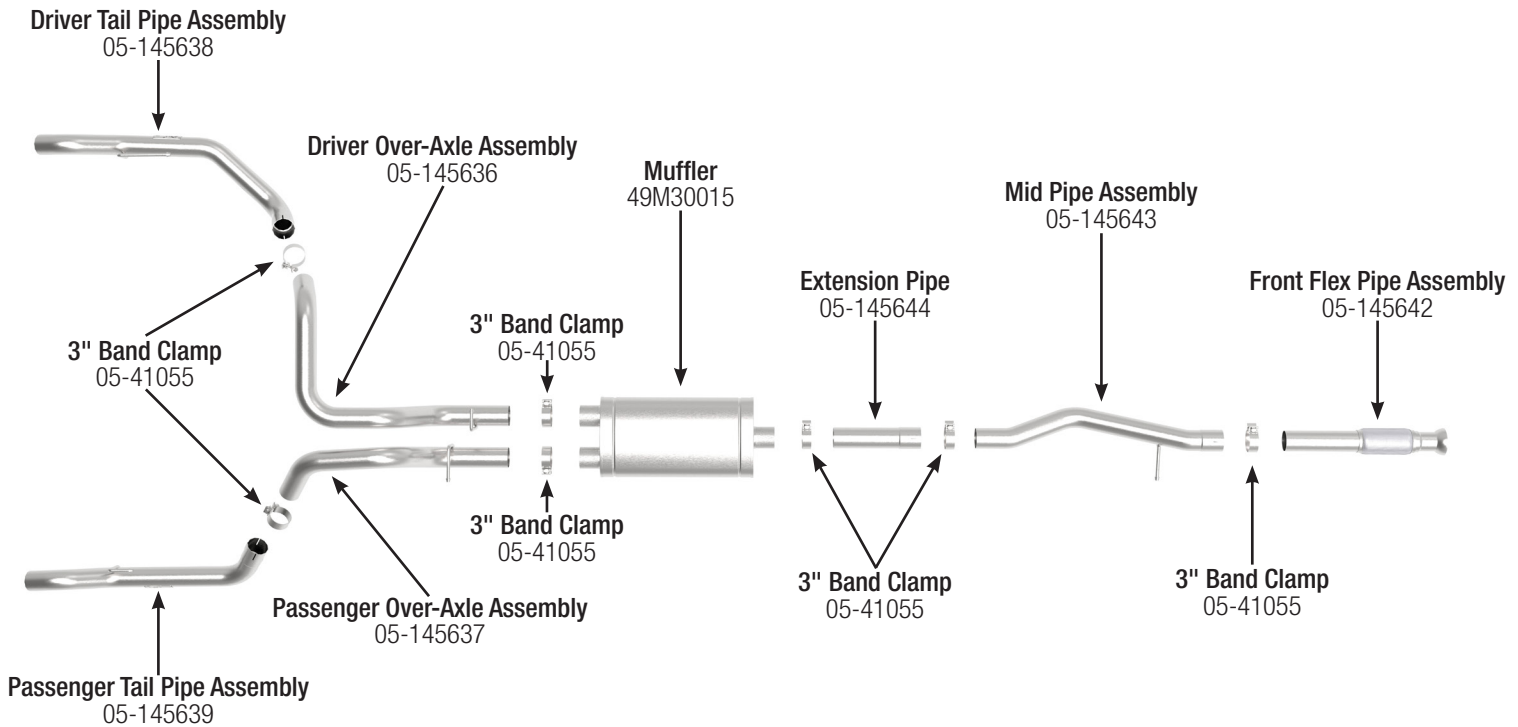

INSTALLATION INSTRUCTIONS

MAKE: Chevrolet / GMC
MODEL: Silverado / Sierra
YEAR: 2019-2023
ENGINE: V8-5.3L

**Vulcan Series
Cat-Back Exhaust
49-34103**



Caution: aFe recommends professional installation on our products. Allow time for your vehicle to cool down prior to installation. When working on or under your vehicle proceed with caution. Exhaust systems reach high temperatures and may cause serious burns. Wear protective safety equipment; eye goggles and gloves to ensure a safe installation.

Step 1: (Read instructions prior to installation.) It is recommended to not fully tighten the exhaust until it has been full installed. Leave loose for adjustability.

NOTE: THIS EXHAUST ONLY FITS THE TRUCKS WITH FACTORY DUAL CUT-OUTS IN THE REAR BUMPER.

Step 2: Remove the O.E. exhaust all the way up to the ball flare connection at the Y-pipe.

Step 3: Install the aFe POWER front pipe using the O.E. band clamp.

Step 4: Install the mid-pipe onto the front pipe using the provided band clamp and O.E. isolation mount.

Step 5: Install the extension pipe using the provided band clamp. Only install the extension pipe for the crew cab / standard bed 156" wheelbase. Do not use extension pipe for the crew cab / short bed or the double cab /standard bed 147" wheelbase.

Step 6: Install the passenger's side over-axle pipe using the provided band clamp and O.E. isolation mounts.

Step 7: Install the driver's side over-axle pipe using the provided band clamp and O.E. isolation mounts.

Step 8: Install the passenger's side tail pipe using the provided band clamp and O.E. isolation mount. The exhaust tube should line up in the middle of the O.E. tip in the bumper.

Step 9: Install the driver's side tail pipe using the provided band clamp and O.E. isolation mount. The exhaust tube should line up in the middle of the O.E. tip in the bumper.

Step 10: Align the exhaust system. Starting from the front of the vehicle, begin tightening down all clamps and hardware.

Step 11: Congratulations your exhaust is now complete. It is recommended to re-check and tighten all exhaust components 50-100 miles after installation.