

advanced FLOW engineering

Dynamic Air Scoop D.A.S.

Instruction Manual P/N: 54-82039

Make: **Dodge** Model: **RAM 2500/3500** Year: **2010-2012** Engine: **L6-6.7L (td) Cummins**



- Please read the entire instruction manual before proceeding.
- Ensure all components listed are present.
- If you are missing any of the components, call customer support at 951-493-7185.
- Ensure you have all necessary tools before proceeding.
- Do not attempt to work on your vehicle when the engine is hot.
- Disconnect the negative battery terminal before proceeding.
- Retain factory parts for future use.

Label	Qty.	Description	Part Number
A	1	Scoop, Rotomold	05-82039B1
B	2	Push-In Rivets	05-60055
C	1	Nut, Hex Head	03-50244
D	2	Washer, M8	03-50065
E	1	Screw, Hex Socket	03-50245



Warranty Information available at: <https://afepower.com/contact#warranty>

Emissions Disclaimer:

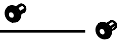
This product is not currently CARB exempt and is not available for purchase in California or for use on any vehicle registered with the California Department of Motor Vehicles.

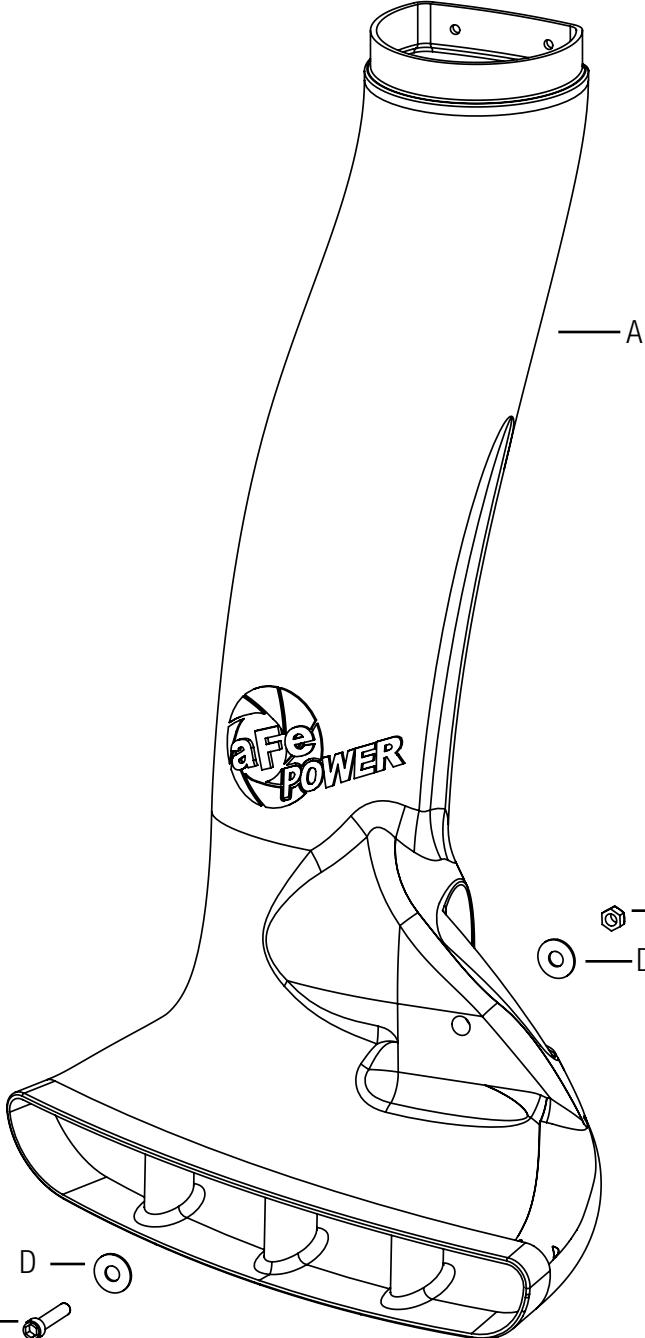
B — 

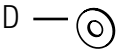

D — 
E — 



C — 
D — 



Figure A

Refer to Figure A for Steps 1-3

Step 1: Slide aFe scoop from under the bumper and connect it to aFe housing.

Step 2: Bolt scoop to frame of truck using furnished M8 screw, washers and nuts.

Step 3: Attach scoop and housing together using push-in (5) plastic.



Figure B

Refer to Figure B for Steps 4

Step 4: Your installation is now complete, Enjoy!



Page left blank intentionally.

Page left blank intentionally.



advanced FLOW engineering, inc.
252 Granite Street Corona, CA 92879
<https://afepower.com/contact>