

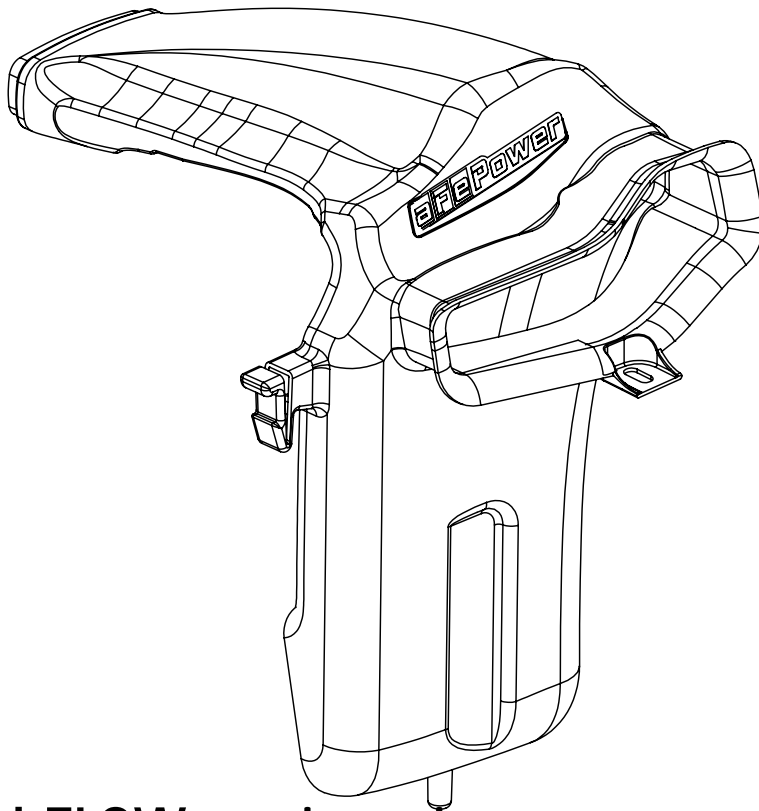

HD
MOMENTUM™



advanced FLOW engineering

Dynamic Air Scoop D.A.S.

Instruction Manual P/N: 54-73006-S

Make: Ford Model: Super Duty F-250/F-350/F-450/F-550 Year: 2017-2019 Engine: V8-6.7L (td) Power Stroke



- Please read the entire instruction manual before proceeding.
- Ensure all components listed are present.
- If you are missing any of the components, call customer support at 951-493-7185.
- Ensure you have all necessary tools before proceeding.
- Do not attempt to work on your vehicle when the engine is hot.

Retain factory parts for future use.

Label	Qty.	Description	Part Number
A	1	Scoop, Rotomold	05-73006B3
B	1	Seal, Trim: 7/16" (8-1/2" in.)	05-00072

Installation will require the following tools:
Panel popper tool.

Warranty Information available at: <https://afepower.com/contact#warranty>

Emissions Disclaimer:

This product is not currently CARB exempt and is not available for purchase in California or for use on any vehicle registered with the California Department of Motor Vehicles.

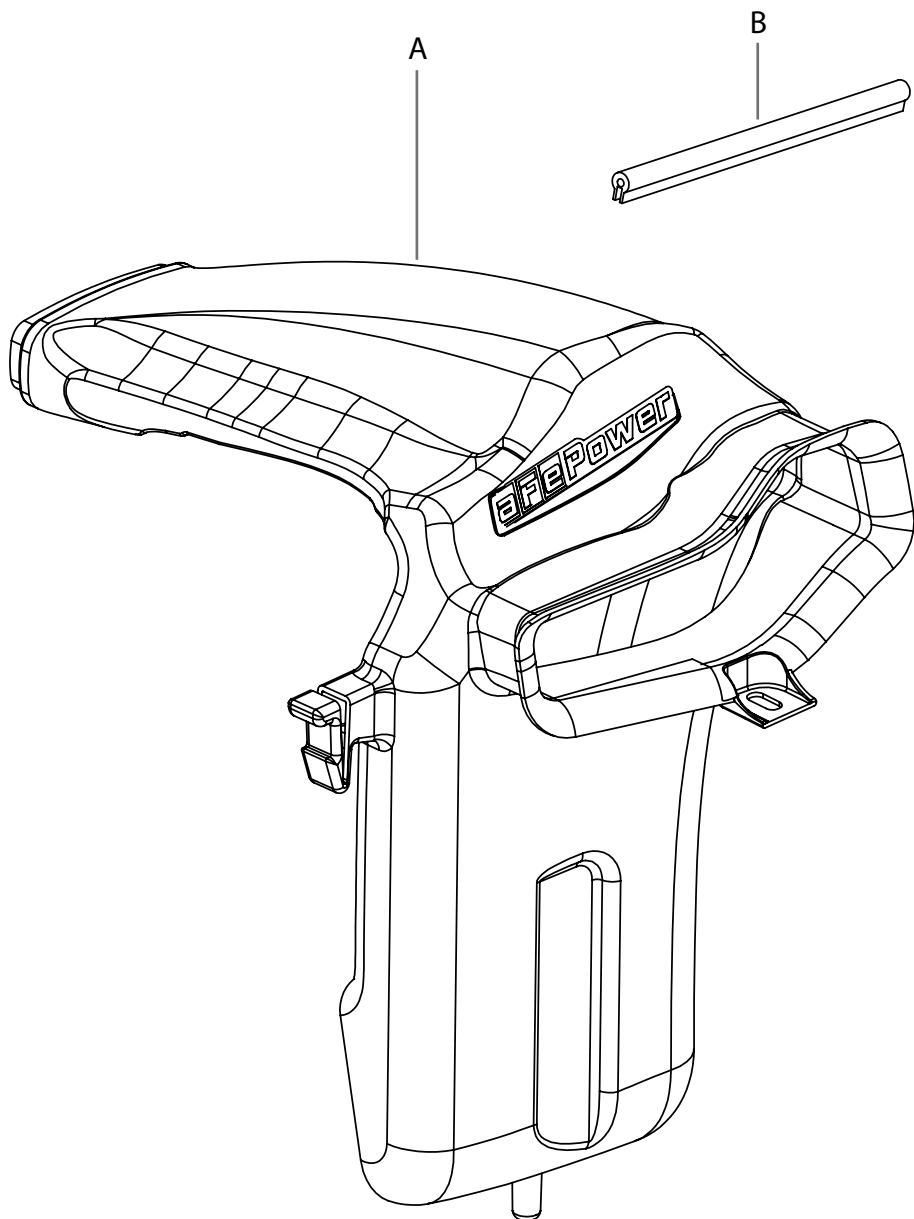



Refer to Figure A for Step 1

Step 1: Remove the two push clips securing OE scoop.



FigureB

Refer to Figure B for Step 2

Step 2: Squeeze the two locking tabs inward and remove OE scoop by pulling in upward motion.



Figure C

Refer to Figure C for Step 3

Step 3: Install aFe scoop into Momentum HD housing and then push scoop down until the two tabs lock into place.

NOTE: Make sure scoop is positioned behind the plastic OE radiator panel.



Figure D

Refer to Figure D for Steps 4-5

Step 4: Replace the two OE push clips removed in Step 1.

Step 5: Install supplied trim seal along the top edge of scoop inlet.

Your installation is now complete. Thank you for choosing aFe POWER!



advanced FLOW engineering, inc.
252 Granite Street Corona, CA 92879
<https://afepower.com/contact>