



P/N
49-46205

JEEP
WRANGLER TJ
1997-2006 I6-4.0L

PERFORMANCE EXHAUST

Features:

- High performance
- First 3" on market
- 100% 409 SS
- Factory style band clamps and hangers
- Design for clearance with popular suspension upgrades

Benefits:

- + 192% flow increase
- + 9 lbs x ft torque
- + 5 H.P.



aFepower.com





Installation Instructions for: JEEP WRANGLER TJ 1997-2006 I6-4.0L



49-46205 (409SS) Cat-Back

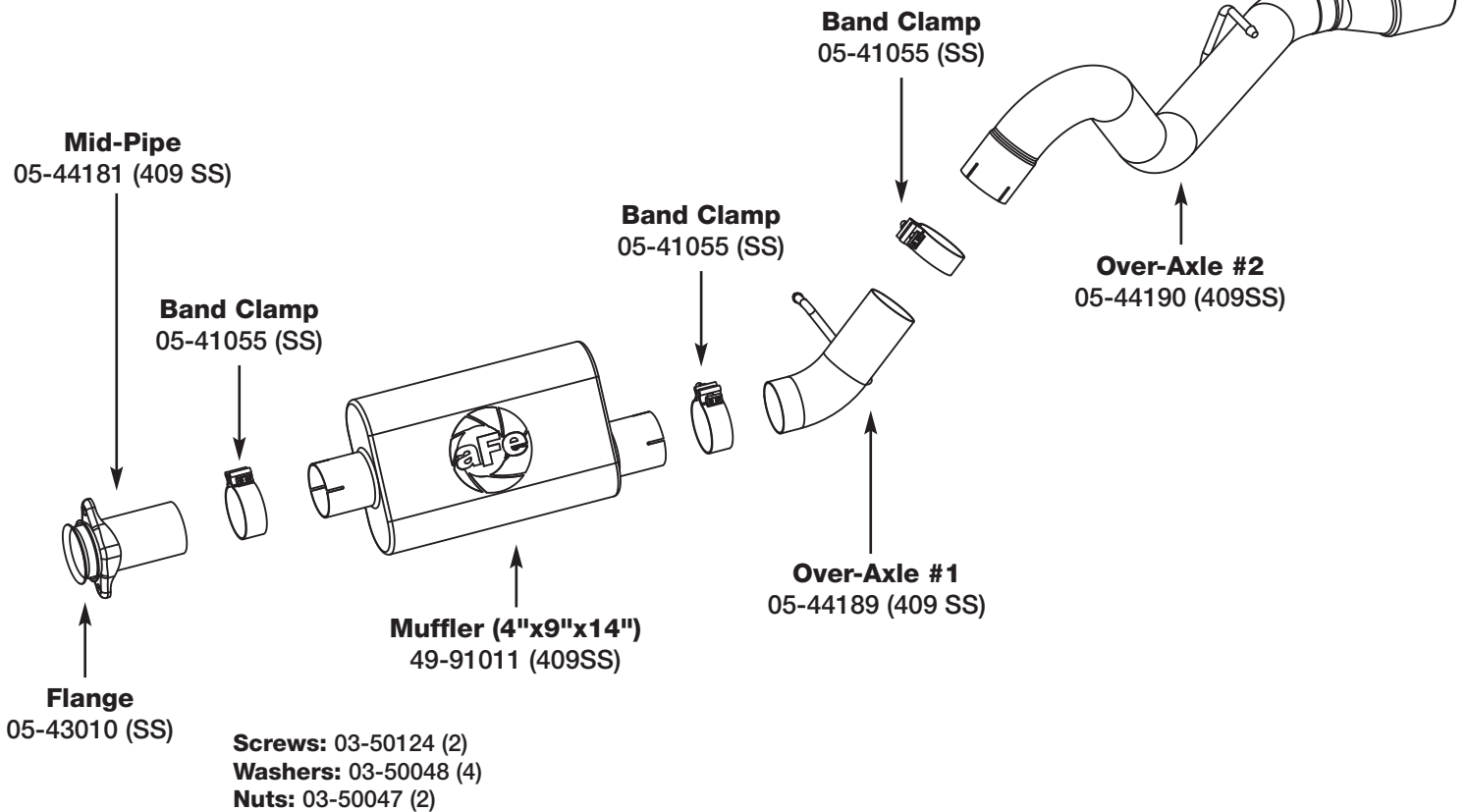

Step 1: (Read Instructions prior to installation) Remove your stock exhaust from the rear of your truck working your way forward. Take caution not to damage the factory isolation mounts as they will be reused. It may be helpful to lubricate the isolation mounts prior to disassembly. **It is recommended to not fully tighten the clamps until the entire system has been installed.**

Step 2: For faster installation spread the pieces of the exhaust along side of your vehicle according to the diagram shown.

Step 3: Assemble over-axle #1 and #2 with a 3" band clamp. Do not fully tighten.

Step 4: Install the over-axle assembly, utilizing the factory isolation mounts. It may be necessary to remove shock absorber.

Step 5: With 3" band clamps install muffler to over-axle assembly. Make sure center inlet on muffler is towards front of vehicle. Offset outlet should face towards rear of vehicle closer to drive shaft.

Step 6: Install mid-pipe with 3" band clamp to muffler. Install and tighten bolts at cat side. Now adjust for alignment, tighten all connections and reinstall shock absorber if removed, tighten to factory specs. Your installation is now complete. It is recommended by aFe to re-tighten all parts after 50-100 miles and continue to check periodically.

NOTE:

- aFe recommends that the tailpipe be at least 1/2"-1" away from any body panels to avoid heat related body damage. **Tighten and secure.**

Caution: Allow time for your vehicle to cool down prior to installation. When working on or under your vehicle proceed with caution. Exhaust systems reach high temperatures and may cause serious burns. Wear protective safety equipment; eye goggles and gloves to ensure a safe installation. **aFe recommends professional installation on our products.**