

advanced FLOW engineering

Cold Air Intake System

Instruction Manual P/N: 51-32412 / 54-32412

Make: **RAM** Model: **2500** Year: **2013-2018** Engine: **L6-6.7L (td)**

Make: **RAM** Model: **3500** Year: **2013-2018** Engine: **L6-6.7L (td)**



- Please read the entire instruction manual before proceeding.
- Ensure all components listed are present.
- If you are missing any of the components, call customer support at 951-493-7185.
- Ensure you have all necessary tools before proceeding.
- Do not attempt to work on your vehicle when the engine is hot.
- Retain factory parts for future use.

Label	Qty.	Description	Part Number
A1	1	Air Filter (Pro DRY S) For 51-32412	21-91064
A2	1	Air Filter (Pro-5R) For 54-32412	24-91064
B	1	Tube	05-32412B1
C	1	Housing	05-32412B2
D	1	Seal Trim 3/4" Bulb (25" inches)	05-00007
E	2	Screw, M4 x 10mm	03-50490
F	1	Screw, M4 x 16mm	03-50489
G	1	aFe Decal	40-10058

Warranty Information available at: <https://afepower.com/contact#warranty>

Emissions Disclaimer:

This intake system is not CARB exempt at this time and is not legal for sale in California or use on vehicles registered with the California Department of Motor Vehicles.

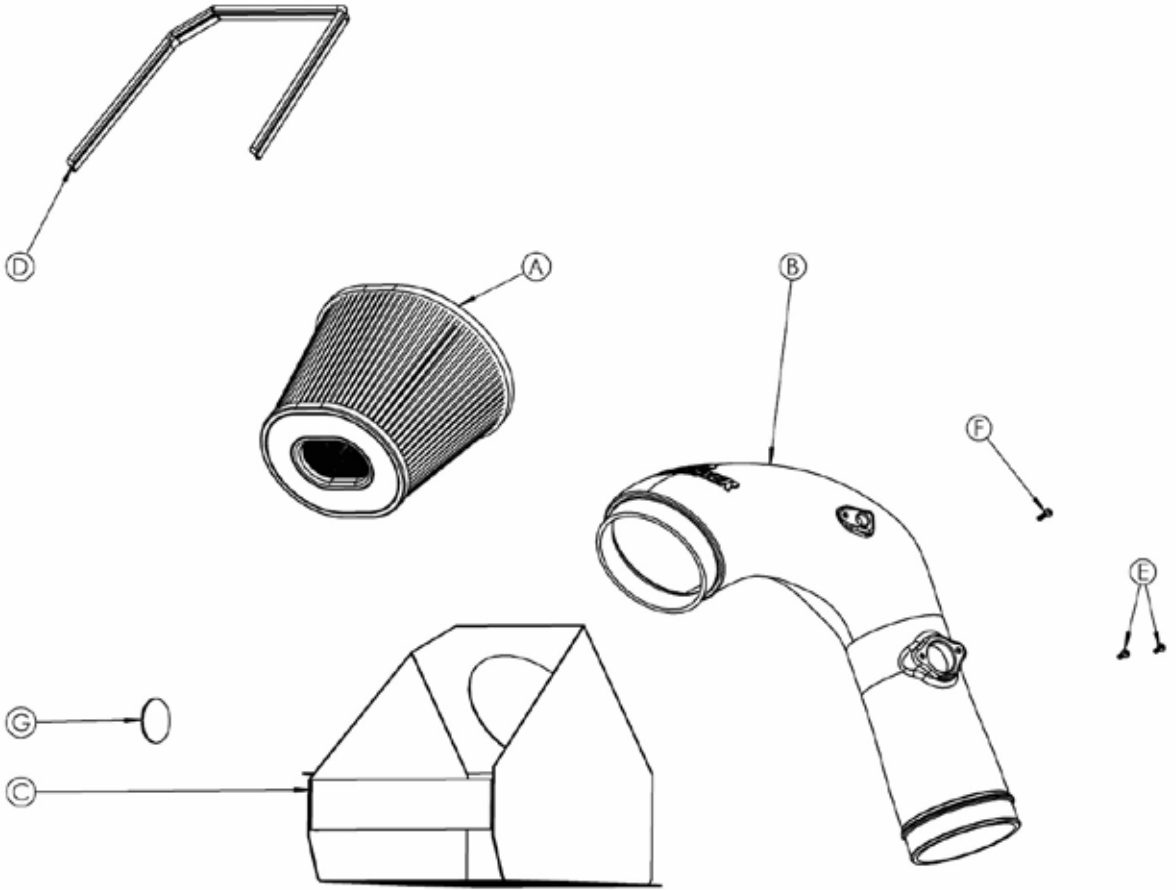



FigureA

Refer to Figure A for Steps 1-2:

Step 1: Remove sensor retaining screws and wire harness tie from filter cover.

Step 2: Remove sensors from cover and lay aside. Do not disconnect sensors from harness during installation, as this will cause a check engine light (1).



Figure B

Refer to Figure B for Step 3:

Step 3: Loosen 3 screws that hold down the cover. Two of the screws will be used on the new filter housing ②



FigureC

Refer to Figure C for Step 4:

Step 4: Loosen the upper band clamp on the turbo inlet elbow. Then remove the filter cover, tube, and filter. Do not discard (3). Keep the lower half of the factory air box in place and the elbow coupling connected to the turbo.



FigureD

Refer to Figure D for Step 5:

Step 5: Pre-assemble filter into housing. Make sure housing is seated in filter retention groove. Install large end of the aFe POWER intake tube into filter and temporarily tighten ④.



Figure E

Refer to Figure E for Steps 6-8:

Step 6: Drop housing and tube assembly into the factory lower half housing and connect the aFe POWER tube to the factory elbow coupling at the turbo..

Step 7: Secure the aFe POWER housing with the two factory screws (5) removed at step 3.

Step 8: Install the aFe POWER decal into the recess onto the aFe power housing.



Figure F

Refer to Figure F for Step 9:

Step 9: Install sensors (Note: Do not disconnect the sensors from the harness). Do not overtighten. Use the longer screw for the MAP sensor ⑥ and use the two short screws for the MAF sensor ⑦. Tighten upper band clamp on turbo inlet elbow.

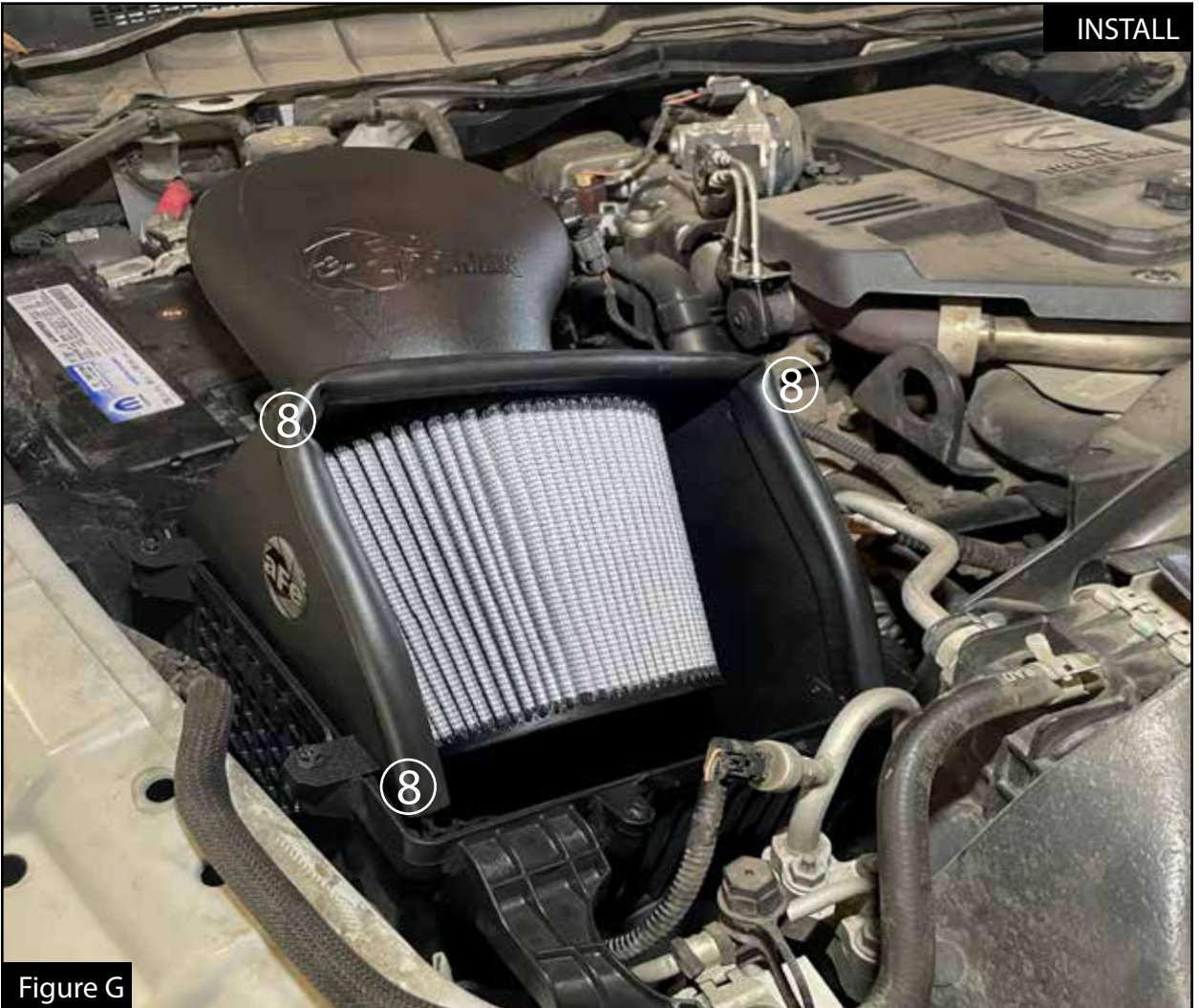
**Figure G**

Refer to Figure G for Steps 10-11:

Step 10: The filter band clamp can now be loosened and filter rotated for final positioning if needed.

Step 11: Install the provided trim seal on the upper edge of housing. It can be trimmed with wire cutters if necessary. Note: There is also an optional cover (Sold separately 54-32418) that can be used to enclose the filter if desired (As shown). To install cover, remove seal trim and place the cover onto the housing. Install the 3 panel nuts and screws to secure cover to housing ⑧.

Page left blank intentionally

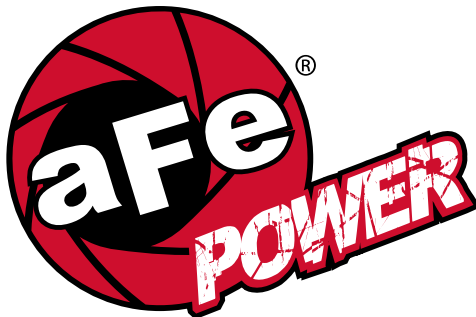

advanced FLOW engineering, inc.
252 Granite Street Corona, CA 92879
<https://afepower.com/contact>