

# Install Instructions

## PRP Seats

### 2019+ Textron Wildcat XX

### Seat Installation



#### Parts

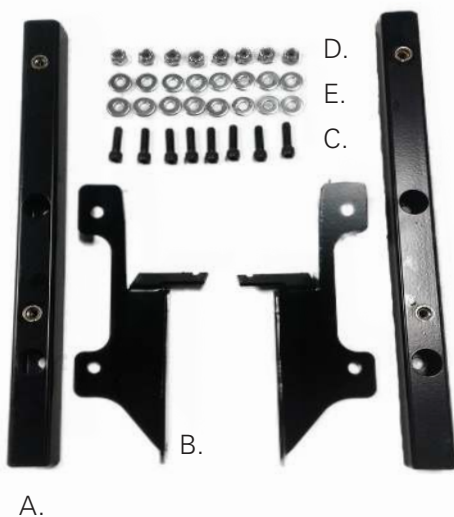

**Read through all of the instructions completely before beginning the install.**

#### Parts Included:

- A. 2 - Square Tube Brackets
- B. 2 - Release Handle Brackets
- C. 8 - 3/16" Allen Head Bolts
- D. 8 - 7/16" Nuts
- E. 16 - Washers

**Remove all parts from the box and unwrap completely using the packaging to lay out the pieces.**

#### Tools Needed: (not included)

- 10mm Socket
- T-25 Torx Socket
- T-27 Torx Socket
- T-30 Torx Socket
- 3/16" Allen Head Wrench or Socket
- 7/16" Wrench
- 10mm Wrench
- Pliers

#### Time:

Approx 30 minutes.

## DRIVER SIDE SEAT INSTALLATION

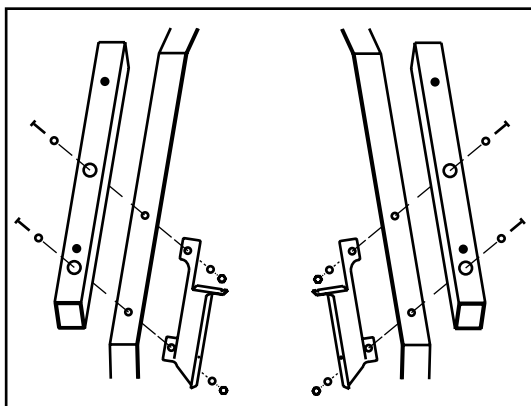
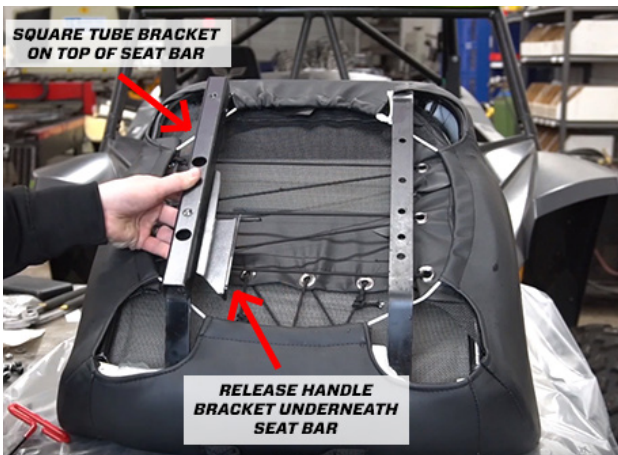

1. Remove the stock seat – release the handle in the back and pull the seat out of the vehicle.
2. Set the stock driver seat upside down on a clean table or workbench.
3. Remove the slider release handle – use pliers to remove both springs, then remove the bolts/nuts on either side using a T-25 Socket and 10mm Wrench. Once the handle is loose, slide it towards the front of the seat to remove it.
4. Next remove the 4 bolts connecting the metal seat base to the frame using a T-25 socket (preferably magnetic tip). Once it is loose, remove the metal seat base by sliding towards the rear of the seat.
5. Then use a T-27 socket to remove the 4 wide head bolts connecting the plastic sliders to the frame. Then remove the plastic sliders.
6. Take the stock seat off the table/ workbench, then take your PRP Seat and lay it face down onto a clean table or workbench.
7. Next install both supplied square tube brackets and release handle brackets to the bottom of your PRP Seat.

Each release handle bracket should be placed underneath each parallel bar (between the bar and the bottom of the seat). Line up each bracket to the corresponding bolt holes located on the parallel bars on the bottom of the seat, and ensure that the tab where the spring will attach to, is oriented towards the rear of the seat (SEE PICTURE).



Then place the supplied Square Tube on top of each parallel bar, with the bolt holes lined up. Use the supplied hardware: 4x 3/16" Allen head bolts, 8x washers, and 4x 7/16" nuts to attach each square tube bracket and release handle bracket to the bottom of the seat. Tighten down all 4 bolts/nuts using a 3/16" Allen and 7/16" wrench. [Torque to 144 in-lbs].



8. Once this is complete, we are going to rebuild the stock slider on the bottom of your PRP Seat.

9. Start by placing the two plastic sliders onto the square tubes. Each slider has two small plastic dots on one end that act as a guide for the metal seat base. Make sure that those dots are oriented towards the front of the seat. Then reattach the sliders using the 4 stock wide head bolts and a T-27 socket. [Torque to 72 in-lbs].



10. Next slide the metal seat base onto the plastic sliders, starting at the rear of the seat, and sliding it forward. The metal base has 4 small holes that should line up with the plastic dots on the sliders. Once the metal base is seated correctly, re-install the 4 stock bolts using a T-25 socket (preferably magnetic tip). [Torque to 36 in-lbs].

11. Now re-connect the sliding release handle. Slide the handle from the front of the seat to the back, making sure that the teeth line up correctly, and that the outside tabs run underneath the newly installed release handle bracket (between the bracket and the seat). Re-install the two stock bolts/nuts on either side of the handle using a T-25 Socket and 10mm Wrench. Then use pliers to re-attach the two springs.



12. Now that the assembly is complete, place the seat back into the vehicle. Make sure that the front bar on the seat base is lined up correctly into the bracket on the floor, and that plastic release handle on the rear of the seat clicks and locks into place.

## **PASSENGER SIDE SEAT INSTALLATION**

1. Remove the stock seat – Use a 10mm socket to remove the two bolts connecting the front of the seat frame to the floor of the vehicle. Then pull the seat forward, releasing the two guide bolts in the back, and remove the seat from the vehicle.
2. Set the passenger seat face down onto a clean table or workbench.
3. Use a T-30 Socket (preferably magnetic tip) to remove the 4 bolts connecting the frame to the bottom cushion, and the 4 bolts connecting the frame to the top (back) cushion.
4. Remove the top and bottom cushions from the frame.
5. Next take your PRP Seat and lay it face down onto a clean table or workbench.
6. Take the passenger seat frame, and lay it over the back/bottom of your PRP Seat, similar to how it was on the stock seat.
7. Using a 3/16" Allen and 7/16" wrench, connect the bottom of your PRP Seat to the stock seat frame using the 4 of the supplied 3/16" Allen Head bolts, 8 - washers, and 4 – 7/16" nuts.



8. **Once the seat is secure to the frame, place it back into the vehicle.**
9. **Make sure both guide bolts fit correctly into the slots on the back, then tighten down the two bolts connecting the front of the seat frame to the floor of the vehicle using a 10mm socket.**
10. **You're all done!**  
Congratulations! Your new PRP Seats for your 2019+ Wildcat XX are installed and ready to use.

If you have any questions or experience issues, please contact your retail outlet first for assistance. However, the staff at PRP is always happy to help at **1-800-317-6253**.

**Thank you! Ride Safe!**