



FITTING INSTRUCTIONS

Part Number: 3550130
 Product RADAR INSTALL KIT
 Description:
 Suited to
 vehicle/s: JEEP GRAND CHEROKEE WK2 2018 ON

ARB 4x4 ACCESSORIES

Corporate Head Office

42-44 Garden St
 Kilsyth, Victoria
 AUSTRALIA 3137

Tel: +61 (3) 9761 6622
 Fax: +61 (3) 9761 6807

Australian enquiries
 North & South American enquiries
 Other international enquiries

sales@arb.com.au
 sales@arb.com.au
 exports@arb.com.au

www.arb.com.au

FITTING REQUIREMENTS

REQUIRED TOOLS FOR FITMENT OF PRODUCT:

BASIC TOOL KIT

HAVE AVAILABLE THESE SAFETY ITEMS WHEN FITTING PRODUCT:

Protective eyewear



Hearing protection



NOTE: 'WARNING' notes in the fitting procedure relate to OHS situations, where to avoid a potentially hazardous situation it is suggested that protective safety gear be worn or a safe work procedure be employed. If these notes and warnings are not heeded, injury may result.

FASTENER TORQUE SETTINGS:

SIZE	Torque Nm	Torque lbft
M6	9Nm	7lbft
M8	22Nm	16lbft
M10	44Nm	32lbft
M12 x1.75	77Nm	57lbft
M12 x 1.25	96Nm	71lbft

PARTS LISTING			
APPLICATION.	PART NO.	QTY	DESCRIPTION
	3750446	1	BRKT MT RADAR WK2 MY18
	6151213	5	BOLT M6 x 1.0 x 20 Gd8.8 BZ
	4581287	5	WASHER SPRING M6 x 2.5 x 1.6 BLK ZN
	4584295	3	WASHER FLAT M6 X 12 X 1.3 BLK ZN
	6151128	3	NUT FLANGE M6 x 1.0 ZP
	6151315	4	NUT CAGED M6 0.7-1.6
	4581082	2	WASHER FLAT, M6 x 19 x 1.6 BZ
	6151443	2	SCREW BTN HD M6 x 20 BZ
	180302	6	CABLE TIE 4.8 X 180 MM BLACK
	6523238	1	PANEL RADAR SURROUND WK2 MY18
	3750445	2	BRKT MT RADAR COVER WK2 MY18
	2125570	1	WARNING CARD RADAR JEEP WK2

FITTING PROCEDURE



1. Remove the radar and mounting plate from the vehicle.



2. Remove the rubber seal from the front by unclipping the 4 side tabs.

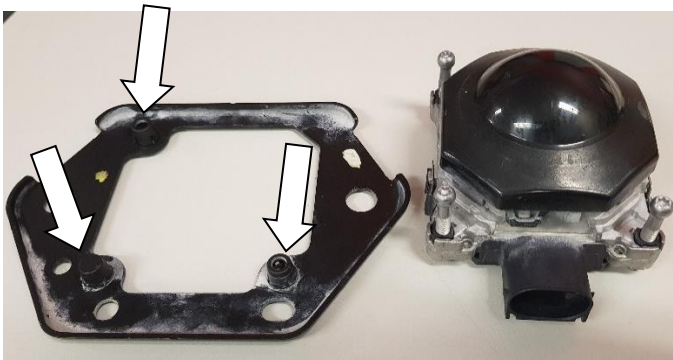

3. Gently pry the radar free of the plastic clips in the mounting plate. Remove the 3 plastic clips from the plate and put aside for later use.



4. Remove the 3 Torx drive ball screws from the radar and refit from the back side. Leave approx. 3 turns of thread visible on the screw. **Do not** bottoming out the bolt into the plastic thread.



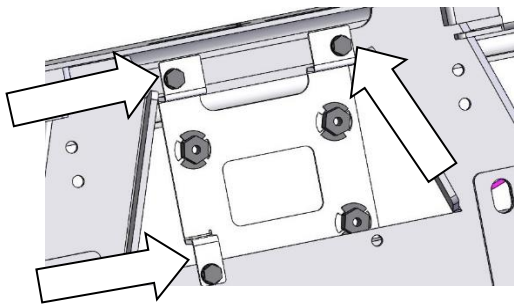

5. Attach the bracket to the bar from the rear as shown using M6 x 20 hex bolts, spring washers, flat washers and flange nuts. Tighten the fasteners to the specified torque.

 M6 - 9 Nm.

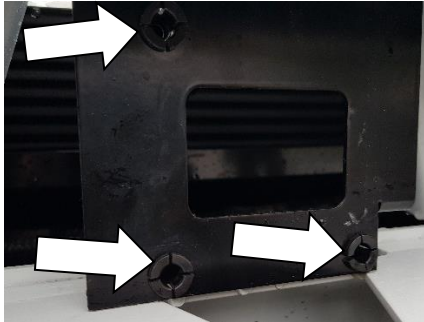

6. Take the plastic clips from step 3. Push them into the 3 holes in the new radar mount from the front of the bull bar.

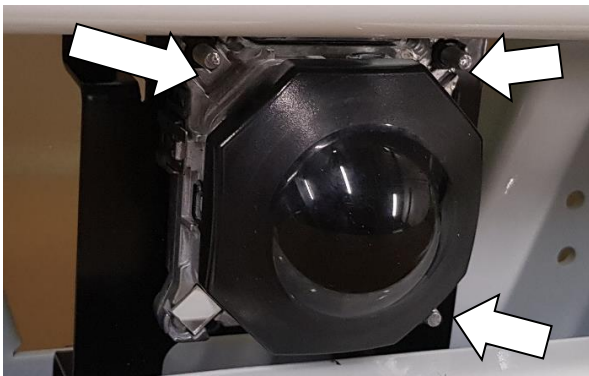

7. Carefully push the radar sensor into the plastic clips ensuring that they all clip in firmly.

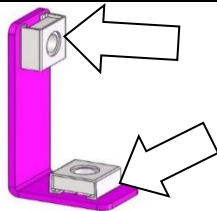

8. Fit 2 x caged nuts to each of the panel brackets as shown.

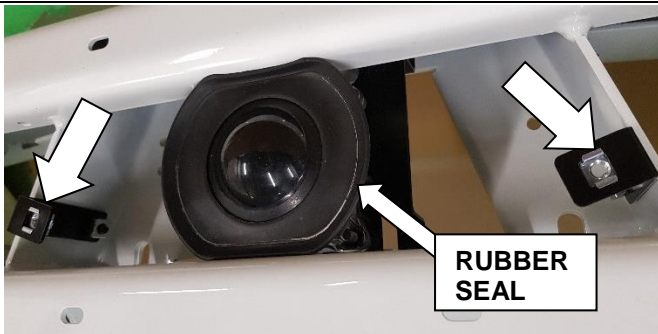

9. Using 2 x M6 bolts with spring and flat washers to attach the 90 Deg mount brackets to the bar.
10. Clip the rubber seal back onto the radar.

 M6 - 9 Nm.



11. Fit the panel over the radar sensor and attach to the panel brackets using 2 x M6 button head cap screws.

Tighten the fasteners to the specified torque.

 M6 - 9 Nm.

Return to the bull bar fitting instructions.