



## Mahindra 2018-20 Roxor 30" LED Hood Mount

Thank you for choosing Rough Country for all your vehicle needs.

Please read instructions before beginning installation. Check the kit hardware against the kit contents shown below. Be sure you have all needed parts and know where they go.

If question exist, please call us @1-800-222-7023. We will be happy to answer any questions concerning this product. Check all fasteners for proper torque. Check to ensure for adequate clearance between all components. Periodically check all hardware for tightness.

**KIT CONTENTS:**

- 30" Single Row LED Light Kit x1
- Driver Side Hood Mount x1
- Pass Side Hood Mount x1

- TOOLS NEEDED:**
- Phillips Bit Driver
  - Soft Cloth
  - Cleaner



**Torque Specs:**

Size	Grade 5	Grade 8	Size	Class 8.8	Class 10.9
5/16"	15 ft/lbs	20ft/lbs	6MM	5ft/lbs	9ft/lbs
3/8"	30 ft/lbs	35ft/lbs	8MM	18ft/lbs	23ft/lbs
7/16"	45 ft/lbs	60ft/lbs	10MM	32ft/lbs	45ft/lbs
1/2"	65 ft/lbs	90ft/lbs	12MM	55ft/lbs	75ft/lbs
9/16"	95 ft/lbs	130ft/lbs	14MM	85ft/lbs	120ft/lbs
5/8"	135ft/lbs	175ft/lbs	16MM	130ft/lbs	165ft/lbs
3/4"	185ft/lbs	280ft/lbs	18MM	170ft/lbs	240ft/lbs



## INSTALLATION INSTRUCTIONS

1. Using a soft cloth clean the surface around the hood hinge and surrounding area. **See Photo 1.**
2. Using a Phillips bit driver remove the (2) rear bolts from the hood hinge and retain for reuse. **See Photo 2.**

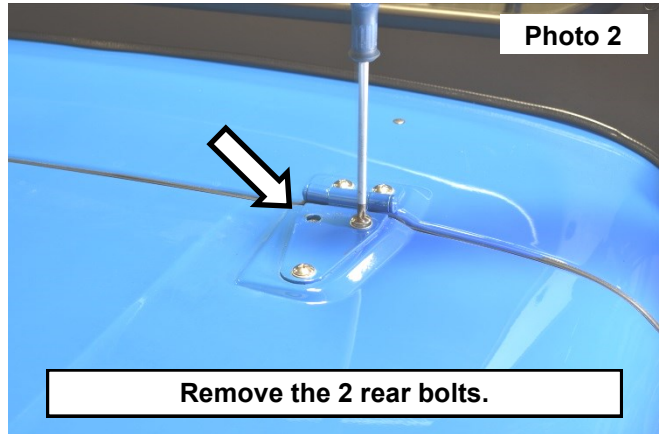
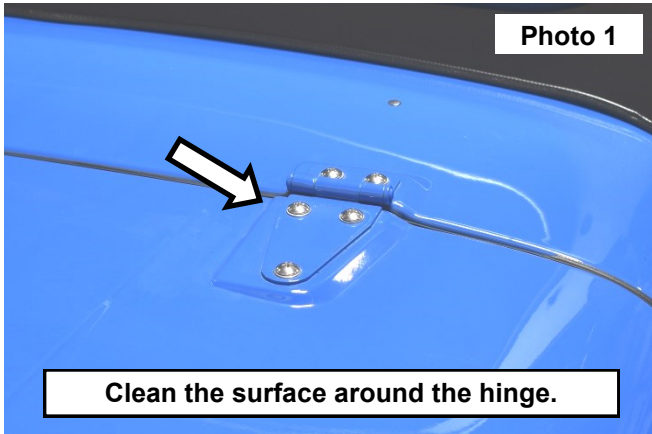

3. Identify the driver and passenger side light mounts. **See Photo 3.**
4. Place the light mount onto the hood hinge aligning the holes use the (2) retained bolts to secure the light mount. Tighten using a Phillips bit driver. **See Photo 4. NOTE: Driver side shown in Photo.**

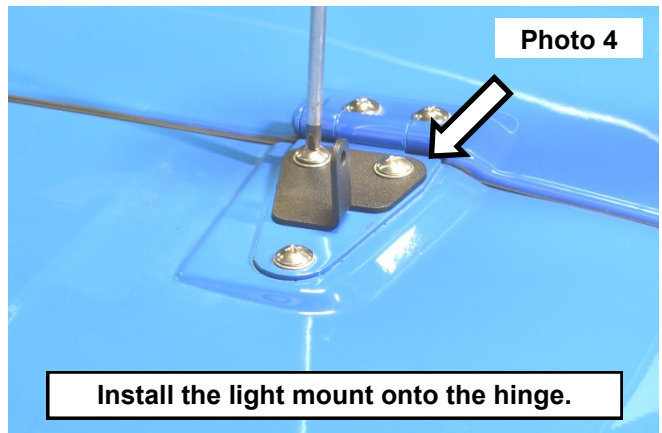
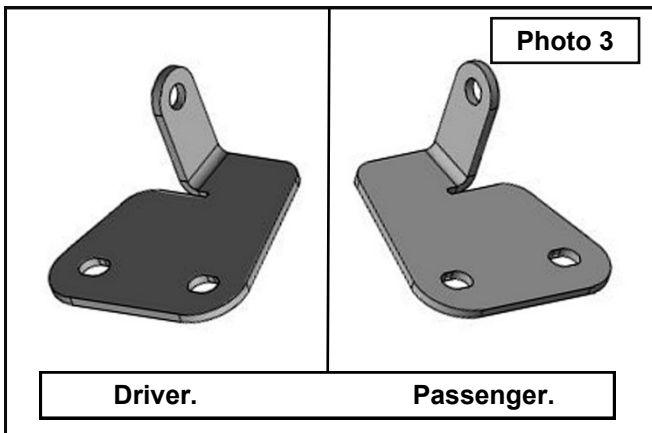

5. Repeat steps 1-4 to install the passenger side light mount onto the vehicle.
6. Install the wiring harness onto the vehicle using the corresponding instruction sheet provided in the 30" LED light kit.
7. Place the 30" light bar in-between the light mounts and connect the wiring harness. Secure the light to the mount using the spacer, washer, lock washer and bolt provided in the 30" light bar kit. **See Photo 5.**
8. Set the light to the desired angle and tighten using the supplied allen wrench. **See Photo 6.**

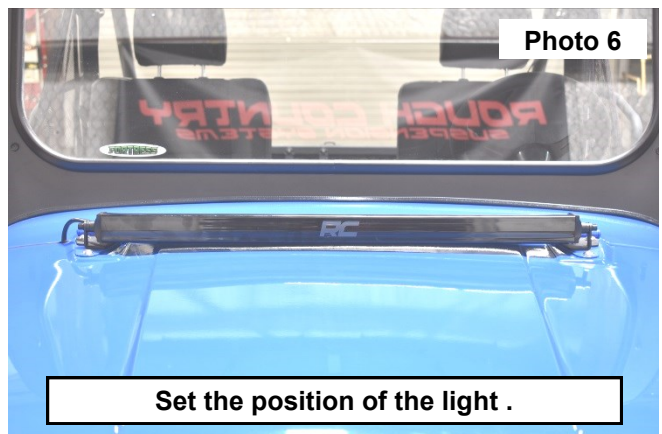
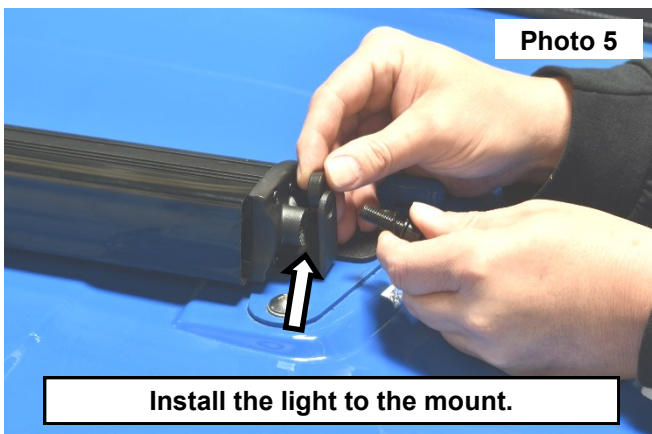

By purchasing any item sold by Rough Country, LLC, the buyer expressly warrants that he/she is in compliance with all applicable, State, and Local laws and regulations regarding the purchase, ownership, and use of the item. It shall be the buyers responsibility to comply with all Federal, State and Local laws governing the sales of any items listed, illustrated or sold. The buyer expressly agrees to indemnify and hold harmless Rough Country, LLC for all claims resulting directly or indirectly from the purchase, ownership, or use of the items.

