

HONDA 2020 Talon 2" Cube Cage Mount

Thank you for choosing Rough Country for all your vehicle needs.

Please read instructions before beginning installation. Check the kit hardware against the kit contents shown below. Be sure you have all needed parts and know where they go.

If question exist, please call us @1-800-222-7023. We will be happy to answer any questions concerning this product. Check all fasteners for proper torque. Check to ensure for adequate clearance between all components. Periodically check all hardware for tightness.

KIT CONTENTS:

- 2" Cube LED Light Kit x1
- Driver Side Cube Mount Bracket x1
- Pass Side Cube Mount Bracket x1

TOOLS NEEDED:

- 14mm Socket x2
- Ratchet

HARDWARE INCLUDED:

- 10mm-1.25 x 50mm Hex Head Bolt x4
- 3/8" Flat Washer x4
- Spacers x4



Torque Specs:

Size	Grade 5	Grade 8	Size	Class 8.8	Class 10.9
5/16"	15 ft/lbs	20ft/lbs	6MM	5ft/lbs	9ft/lbs
3/8"	30 ft/lbs	35ft/lbs	8MM	18ft/lbs	23ft/lbs
7/16"	45 ft/lbs	60ft/lbs	10MM	32ft/lbs	45ft/lbs
1/2"	65 ft/lbs	90ft/lbs	12MM	55ft/lbs	75ft/lbs
9/16"	95 ft/lbs	130ft/lbs	14MM	85ft/lbs	120ft/lbs
5/8"	135ft/lbs	175ft/lbs	16MM	130ft/lbs	165ft/lbs
3/4"	185ft/lbs	280ft/lbs	18MM	170ft/lbs	240ft/lbs



INSTALLATION INSTRUCTONS

1. Remove the (2) lower cage mounting bolts using (2) 14mm sockets. Retain the nuts. **See Photo 1.**
2. Drivers side shown. Locate the mounting bracket and install (2) of the supplied 10mm-1.25 x 50mm Hex Head Bolts and (2) 3/8" Flat Washers in to the bracket. **See Photo 2.**

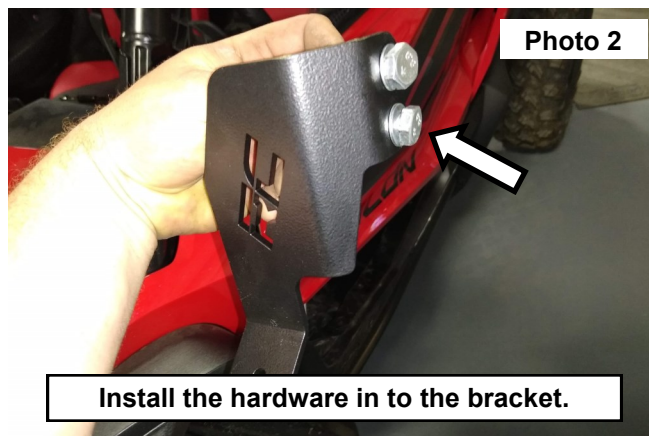
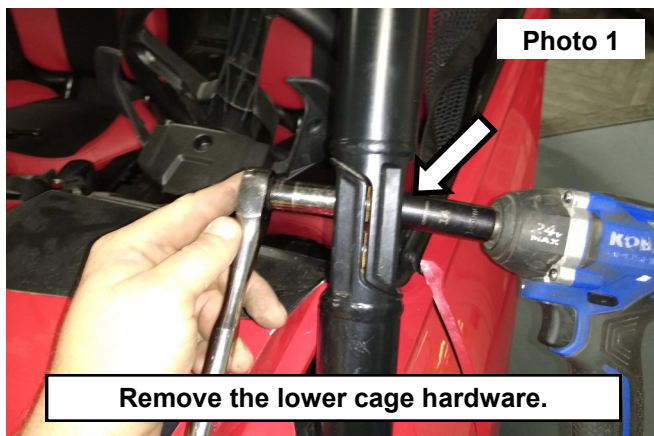

3. Install (2) of the supplied spacers onto the bolts on the inside of the mounting bracket. **See photo 3.**
4. Install the mounting bracket and the bolts into the lower cage mount. Secure using (2) of the supplied 10mm-1.25 x 50mm and (2) 3/8" Flat Washers. Install the retained nuts onto the bolts and tighten using a 14mm sockets. **See Photo 4.**

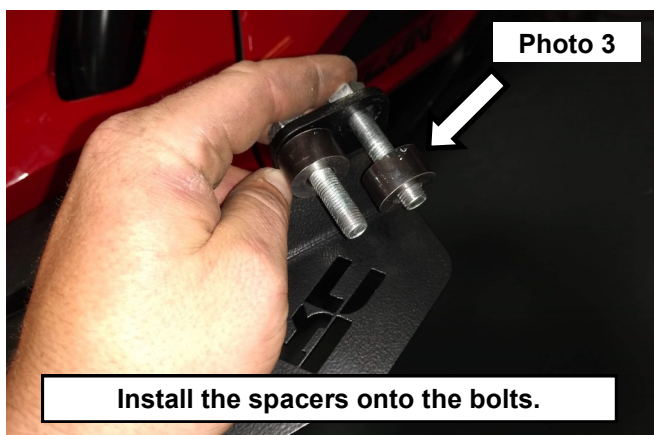

5. Repeat this process on the opposite side of the UTV.
6. Install the 2" cube mounts onto the Driver and Passenger side brackets. **See Photo 5.**
7. Install the wiring harness to the cube lights and connect to the battery / power supply on the UTV.



By purchasing any item sold by Rough Country, LLC, the buyer expressly warrants that he/she is in compliance with all applicable, State, and Local laws and regulations regarding the purchase, ownership, and use of the item. It shall be the buyers responsibility to comply with all Federal, State and Local laws governing the sales of any items listed, illustrated or sold. The buyer expressly agrees to indemnify and hold harmless Rough Country, LLC for all claims resulting directly or indirectly from the purchase, ownership, or use of the items.

