

ROUGH COUNTRY

SUSPENSION SYSTEMS®

05-15 Ford Super Duty 6" & 8" 4-Link Kit

Thank you for choosing Rough Country for your suspension needs.

Rough Country recommends a certified technician installs this system. In addition to these instructions, professional knowledge of disassemble/reassembly procedures as well as post installation checks must be known. Attempts to install this system without this knowledge and expertise may jeopardize the integrity and/or operating safety of the vehicle.

Please read all the instructions before beginning the installation. Check the kit hardware against the parts list and the kit contents on the back of these instructions. Be sure you have all the needed parts and understand where they go. Also please review the tools needed list and make sure you have needed tools.

PRODUCT USE INFORMATION

⚠ WARNING As a general rule, the taller a vehicle is, the easier it will roll. We strongly recommend, because of rollover possibility, that seat belts and shoulder harnesses should be worn at all times. Avoid situations where a side roll-over may occur.

Generally, braking performance and capability are decreased when larger/heavier tires and wheels are used. Take this into consideration while driving. Do not add, alter, or fabricate any factory or after-market parts to increase vehicle height over the intended height of the Rough Country product purchased. Mixing component brands is not recommended.

Rough Country makes no claims regarding lifting devices and excludes any and all implied claims. We will not be responsible for any product that is altered. We will be happy to answer any questions concerning the design, function, and correct use of our products by calling our toll free number @ 1-800-222-7023.

NOTICE TO DEALER AND VEHICLE OWNER

Any vehicle equipped with any Rough country product must have the "Warning to Driver" decal installed on the sun visor or dash. The decal is to act as a constant reminder for whoever is operating the vehicle of its unique handling characteristics. **INSTALLING DEALER**—It is your responsibility to install the warning decal and to forward these installation instructions on too the vehicle owner for review and to be kept in the vehicle for its service life.

Kit Contents:

- (2) Upper Control Arms
- (2) Lower Control Arms
- (2) Control Arm Bracket
- (1) Hardware Bag
- (1) Instruction Sheet Bag

Tools Needed:

- 1 1/8" Wrench
- 1 7/8" Wrench
- 24mm Socket
- 24mm Wrench

Torque Specs:

Size	Grade 5	Grade 8
5/16"	15 ft/lbs	20 ft/lbs
3/8"	30 ft/lbs	35 ft/lbs
7/16"	45 ft/lbs	60 ft/lbs
1/2"	65 ft/lbs	90 ft/lbs
9/16"	95 ft/lbs	130 ft/lbs
5/8"	135 ft/lbs	175 ft/lbs
3/4"	185 ft/lbs	280 ft/lbs

1. Using a 24mm wrench and socket remove the bolt holding in radius arm to the frame. Using a 24mm wrench, and socket remove the bolts holding the radius arm to the axle. Retain stock hardware for reuse.
2. Insert bushings, and sleeves from kit bag into both ends of the upper radius arm. **See Photo 1.**
3. Insert the radius arm drop bracket into the stock location. Bolt into place using a 3/4" x4.75" bolt, crush sleeves, nut and washer provided in the kit bag. Do not tighten at this time. **See Photo 2.**



Photo 1

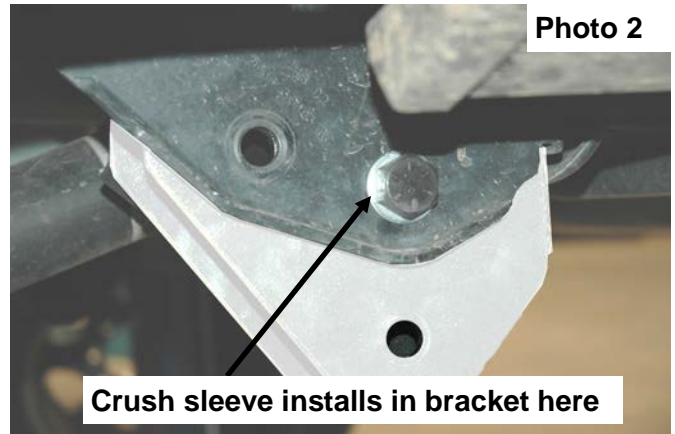

Photo 2

Crush sleeve installs in bracket here

4. Attach the upper radius arm to the radius arm drop bracket in the top hole. Bolt into place using a 3/4" x4.75" bolt, nut and washer provided in the kit bag. Do not tighten at this time.
5. Attach the radius arms to the axle using the stock hardware. **See Photo 3.** It may be necessary to use the rear nut from the frame mount due to some models having the radius arm nut welded to the radius arm.

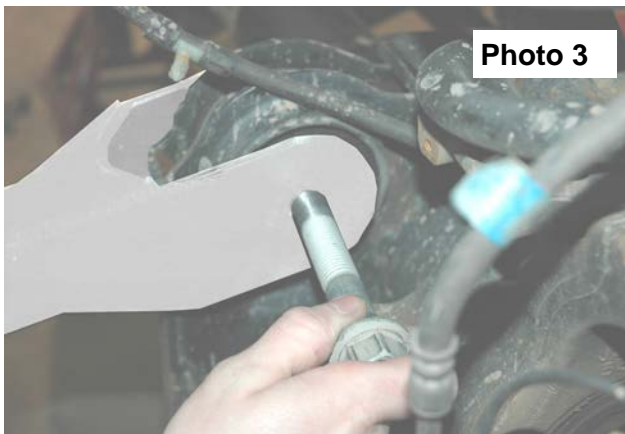

Photo 3

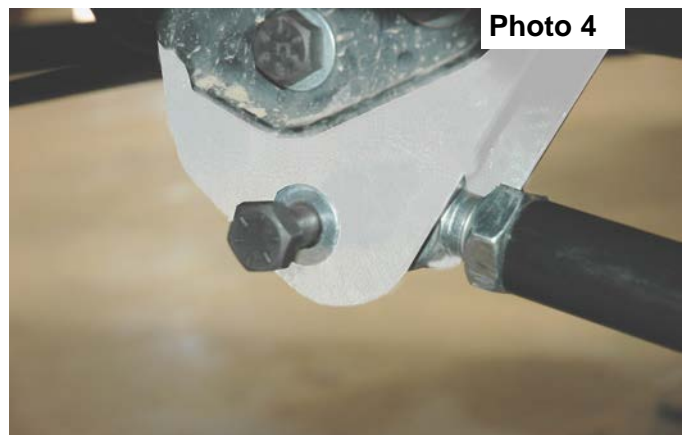

Photo 4

6. Insert the adjustable end of the lower radius arm into the radius arm drop bracket as shown in **Photo 7.** Bolt into place using a 3/4" x4.75" bolt, nut and washer provided in the kit bag. Using a 1 7/8" wrench tighten the jam nut. Center of end to center hole of opposite end should be 36 1/8". Reattach the ABS wire to the upper radius arm. **See Photo 4.**
7. Repeat steps 1-6 on the opposite side.

POST INSTALLTION INSTRUCTIONS

1. Adjust steering wheel to re-center prior to driving.
2. Check all fasteners for proper torque. Check to ensure for adequate clearance between all rotating, mobile, fixed, and heated members. Verify clearance between exhaust and brake lines, fuel lines, fuel tank, floor boards and wiring harness. Check steering gear for clearance. Test and inspect brake system.
3. Perform steering sweep to ensure front brake hoses have adequate slack and do not contact any rotating, mobile or heated members. Inspect rear brake hoses at full extension for adequate slack. Failure to perform hose check/ replacement may result in component failure. Longer replacement hoses, if needed can be purchased from a local parts supplier.
4. Have a qualified alignment center realign front end to
 - Caster min- 4.0 degree
 - Camber -0.6—.09 degree
 - Toe -.10- .15 degree
5. Install Warning to Driver decal on sun visor.
6. Re-torque all nuts, bolts, and especially u-bolts after the first 100 miles, again after another 100 miles and then check periodically thereafter.
7. All components must be retightened after 500 miles, and every three thousand miles after installation
8. Adjust headlights to proper settings.

KIT CONTENTS

Radius Arm Brkts

Front Upper Arms



Front Lower Arms

Thank you for choosing Rough Country for your suspension needs.

